

2005 ACCESSORIES AND EQUIPMENT

Mirrors - Pilot

COMPONENT LOCATION INDEX

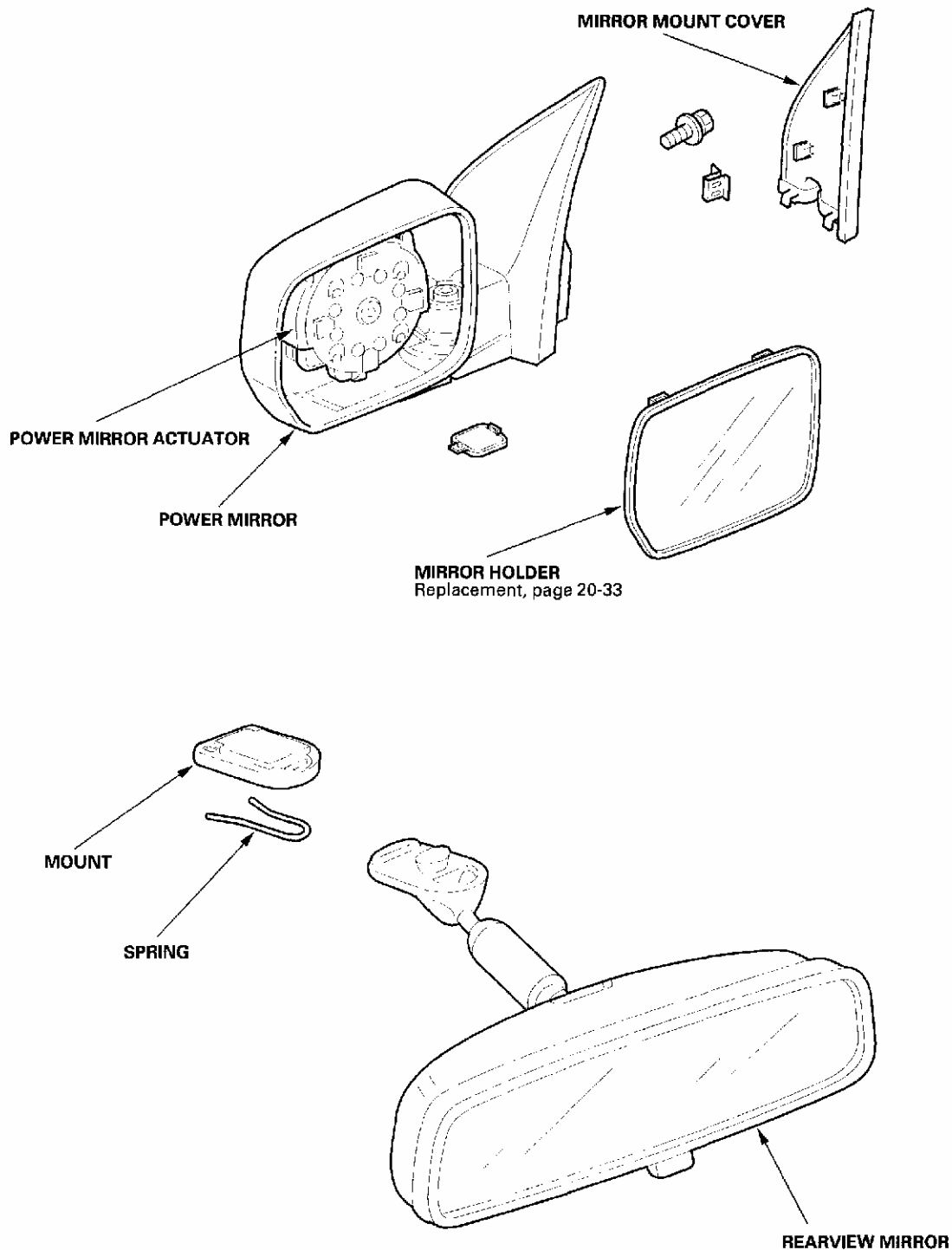

**Fig. 1: Identifying Mirrors Component Location**

## POWER MIRROR REPLACEMENT

1. Lower the door glass fully.
2. Carefully detach the clips, and release the hooks (A, B), then pry out the mirror mount cover (C) by hand in the sequence shown.

### Fastener Locations

▷ : Clip, 2

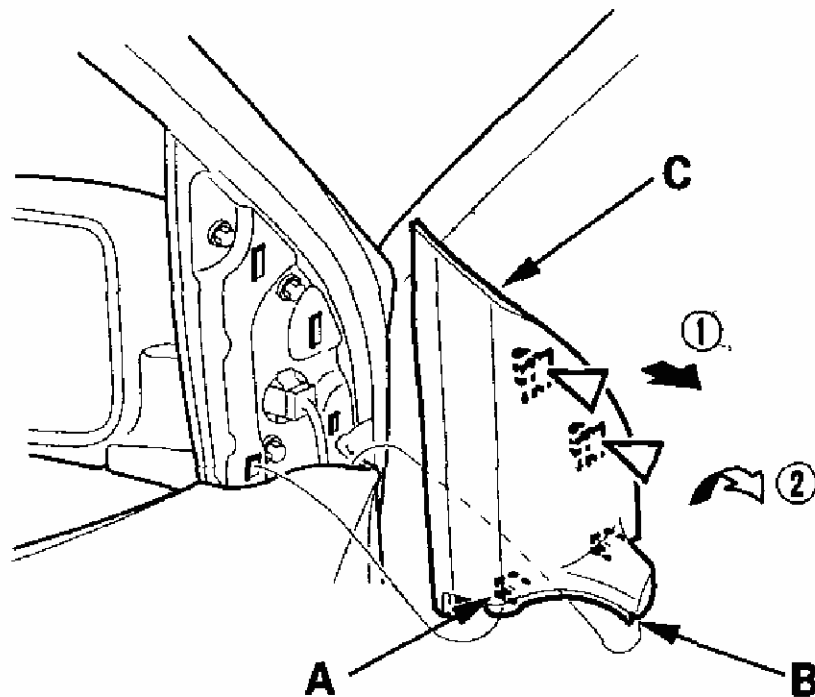
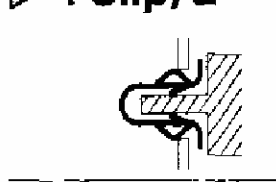
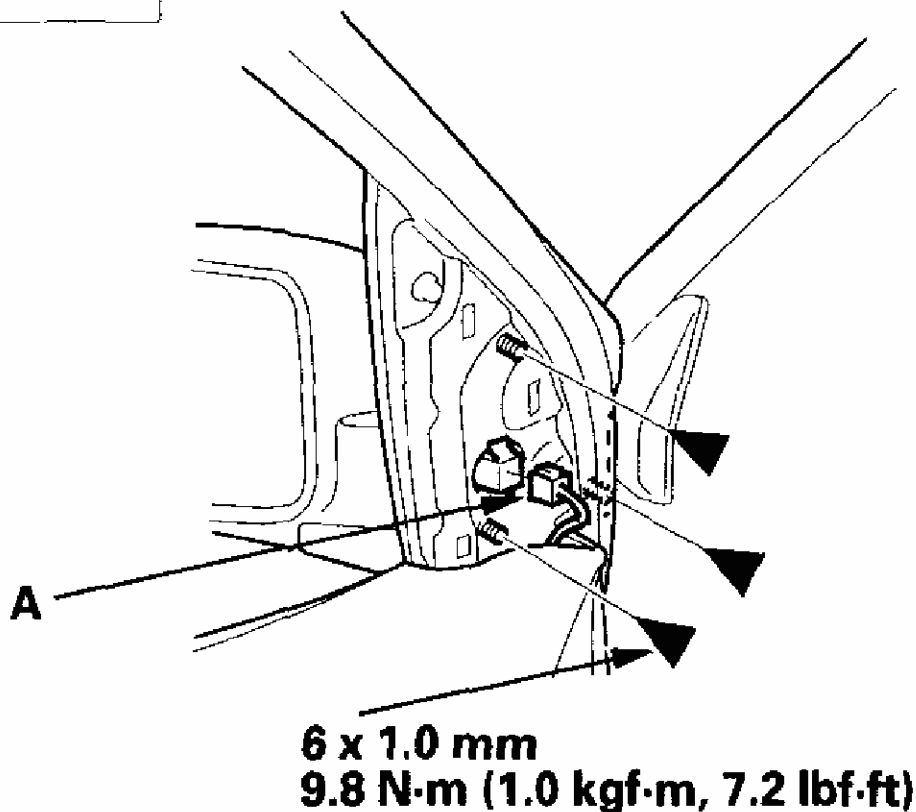

**Fig. 2: Detaching Clips**

3. Disconnect the connector (A).

## Fastener Locations

► : Bolt, 3



**Fig. 3: Disconnecting Connector**

4. While holding the mirror, remove the bolts securing the mirror.
5. While holding the mirror, push in on the connector clips (A), then push out to remove the mirror (B). Take care not to scratch the door.

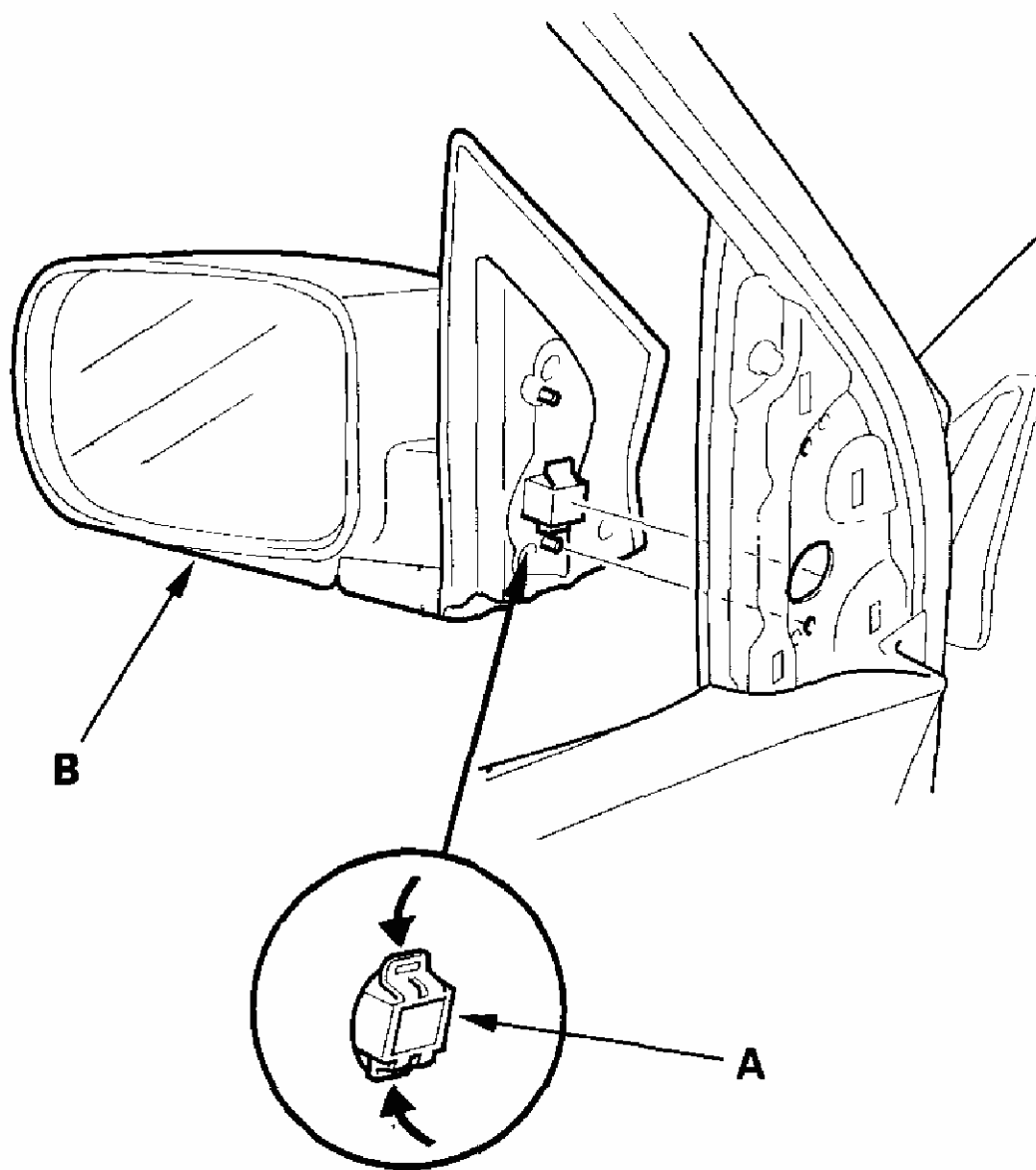
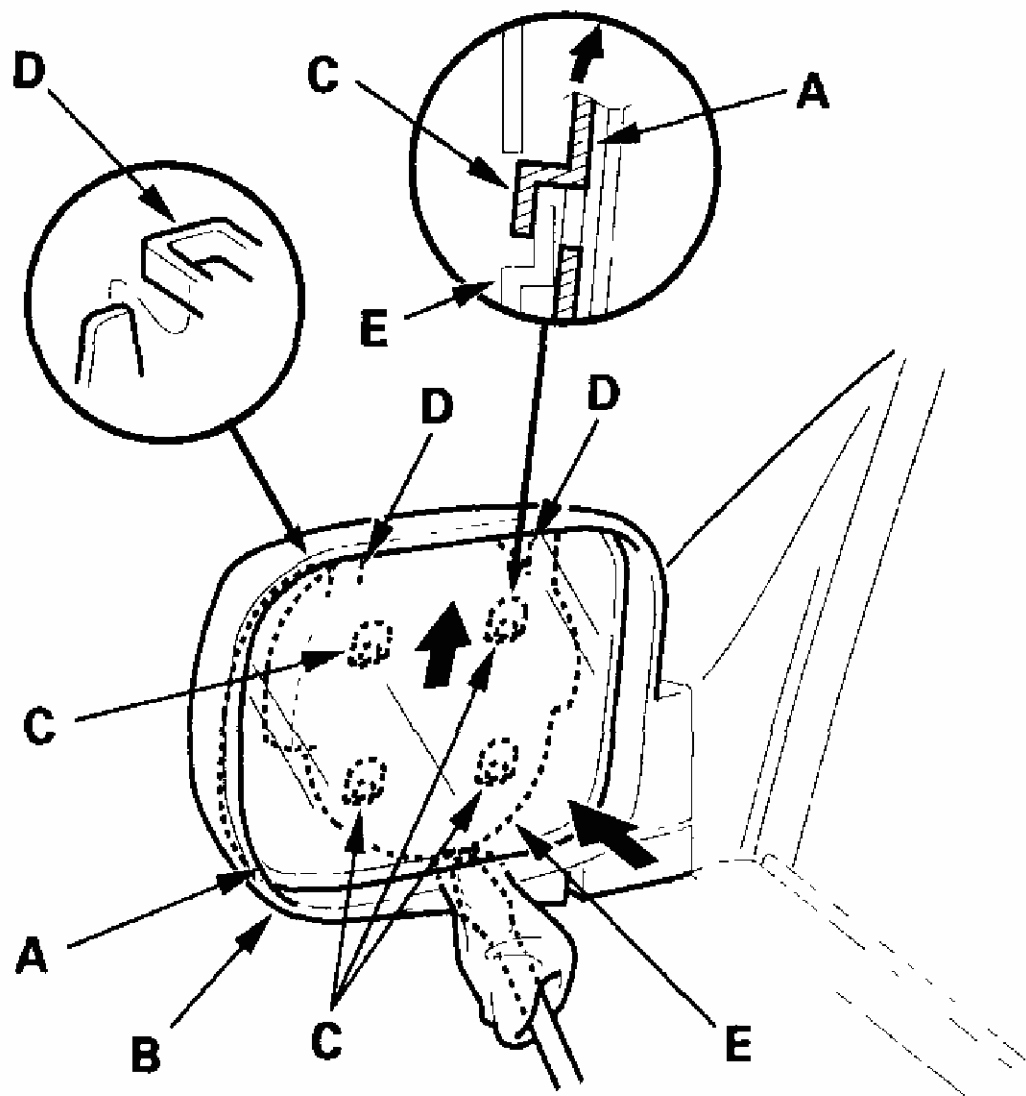

**Fig. 4: Pushing In Connector Clips**

6. Install the mirror in the reverse order of removal, and note these items:
  - Make sure the connector is plugged in properly.
  - Replace any damaged clips.
  - Push the clips into place securely.

## **MIRROR HOLDER REPLACEMENT**

1. Push in the bottom of the mirror holder (A).



**Fig. 5: Pushing In Bottom Of Mirror Holder**

2. Insert a flat-tip screwdriver wrapped with a shop towel at the bottom gap between the mirror holder and mirror (B). Push the mirror holder upward to release the hooks (C, D) from the actuator adapter plate (E) while holding the mirror holder.
3. If equipped, disconnect the mirror defogger terminals (A).

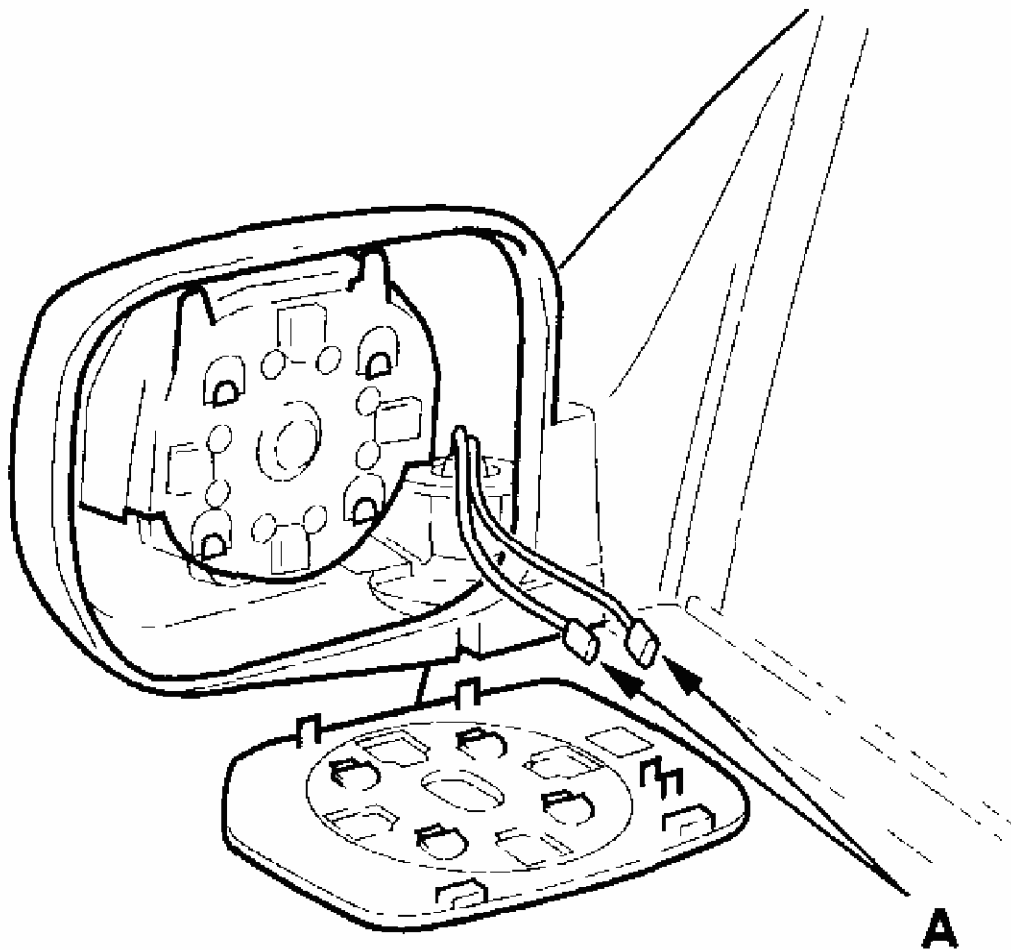
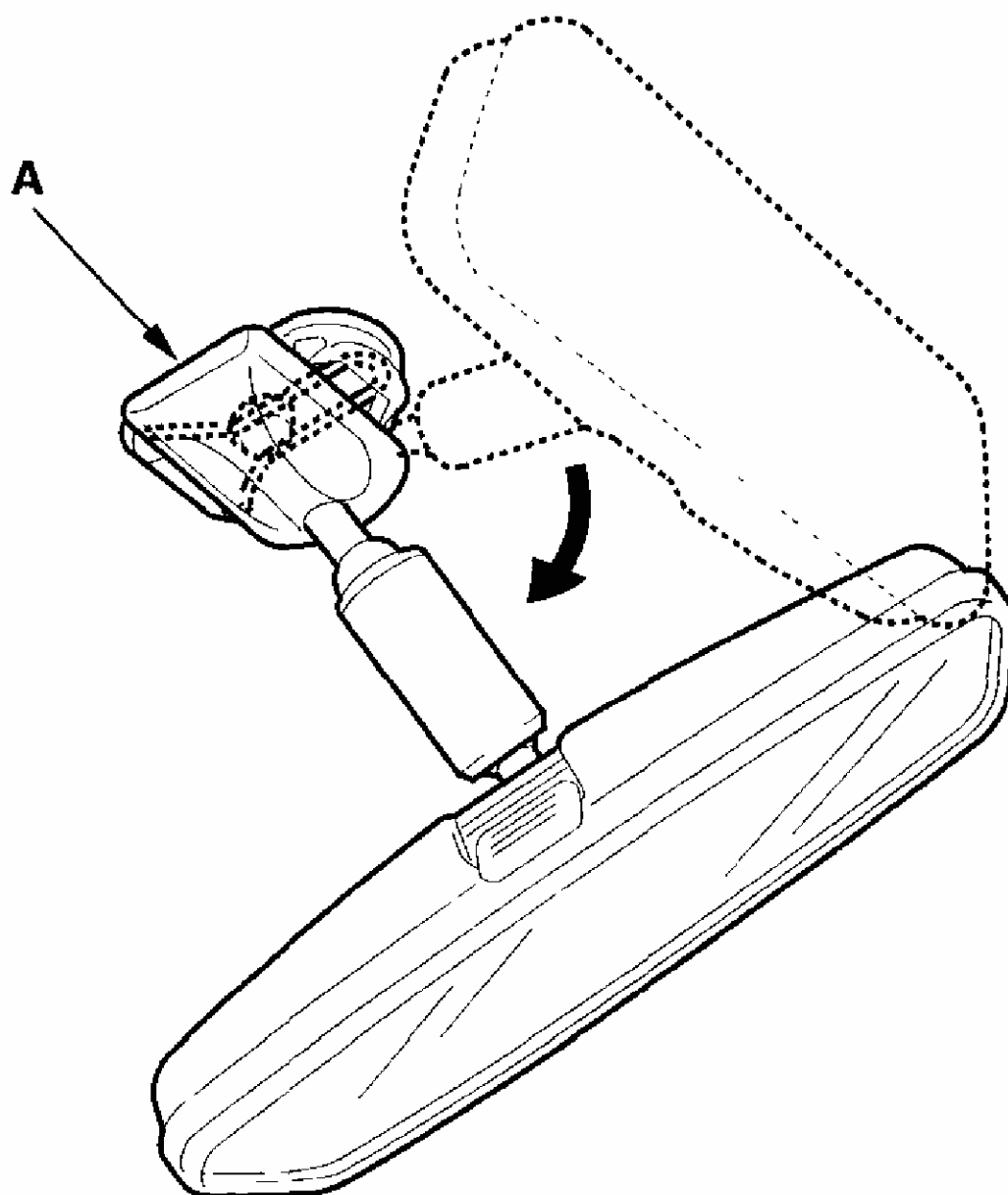

**Fig. 6: Pushing Mirror Holder**

4. Install the mirror holder in the reverse order of removal, and note these items:
  - Make sure the terminals are plugged in properly.
  - Push the mirror holder downward to lock in the hooks.
  - Push in the bottom of the mirror fully before you push on the mirror holder.
  - Check the operation of the actuator.

## **REARVIEW MIRROR REPLACEMENT**

1. Turn the rearview mirror base (A) 90 °.



**Fig. 7: Turning Rearview Mirror Base**

2. Slide the rearview mirror (A) down toward the bottom of the windshield to detach it from the spring (B) in the mount (C).

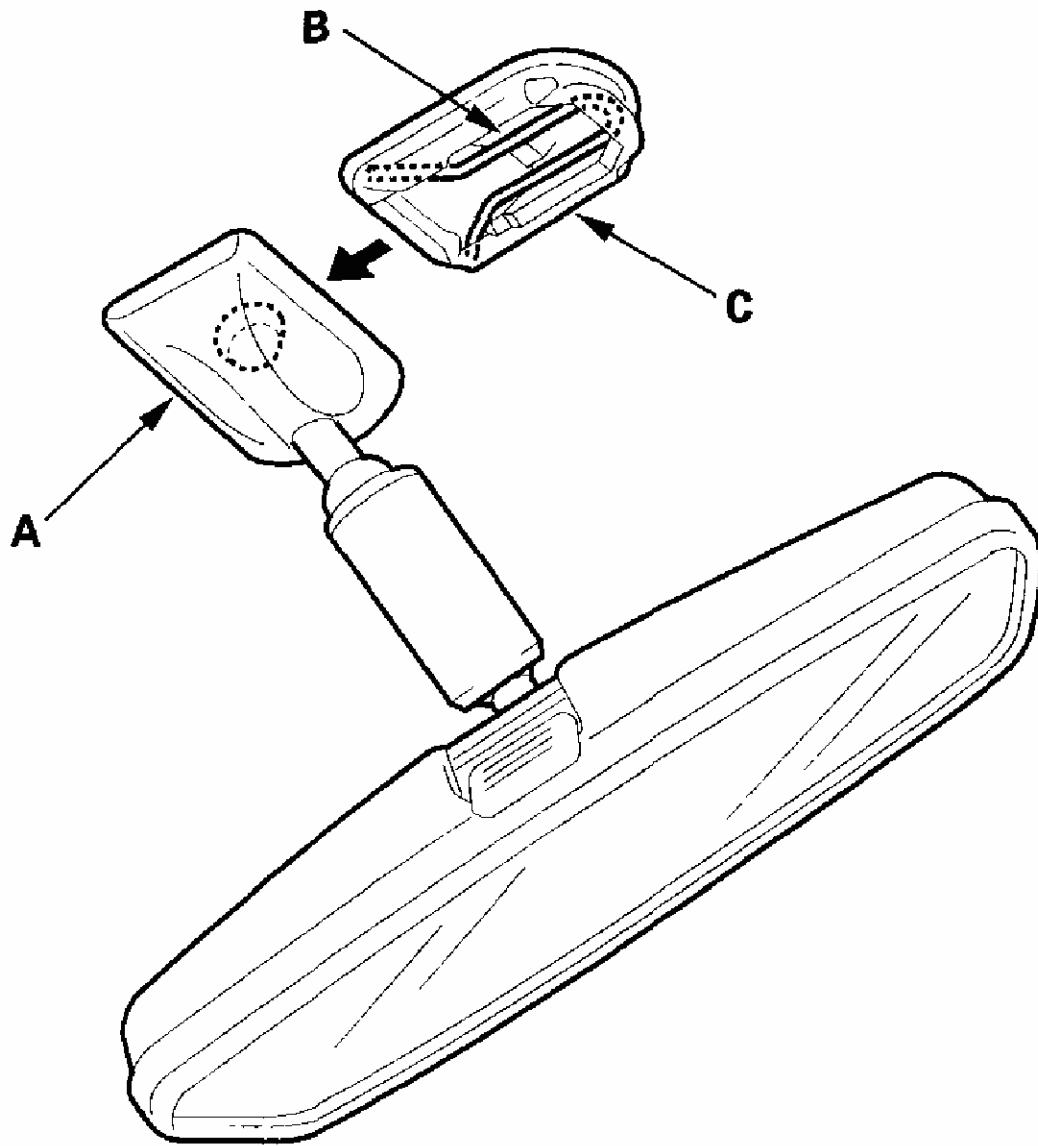

**Fig. 8: Sliding Rearview Mirror Down Of Windshield**

3. If necessary, remove the spring from the mount.
4. Install the rearview mirror in the reverse order of removal.



<b>2005 Honda Pilot EX</b>
2005 ACCESSORIES AND EQUIPMENT Mirrors - Pilot