

2003-04 ACCESSORIES & EQUIPMENT

Interior Trim - Pilot

COMPONENT LOCATION INDEX

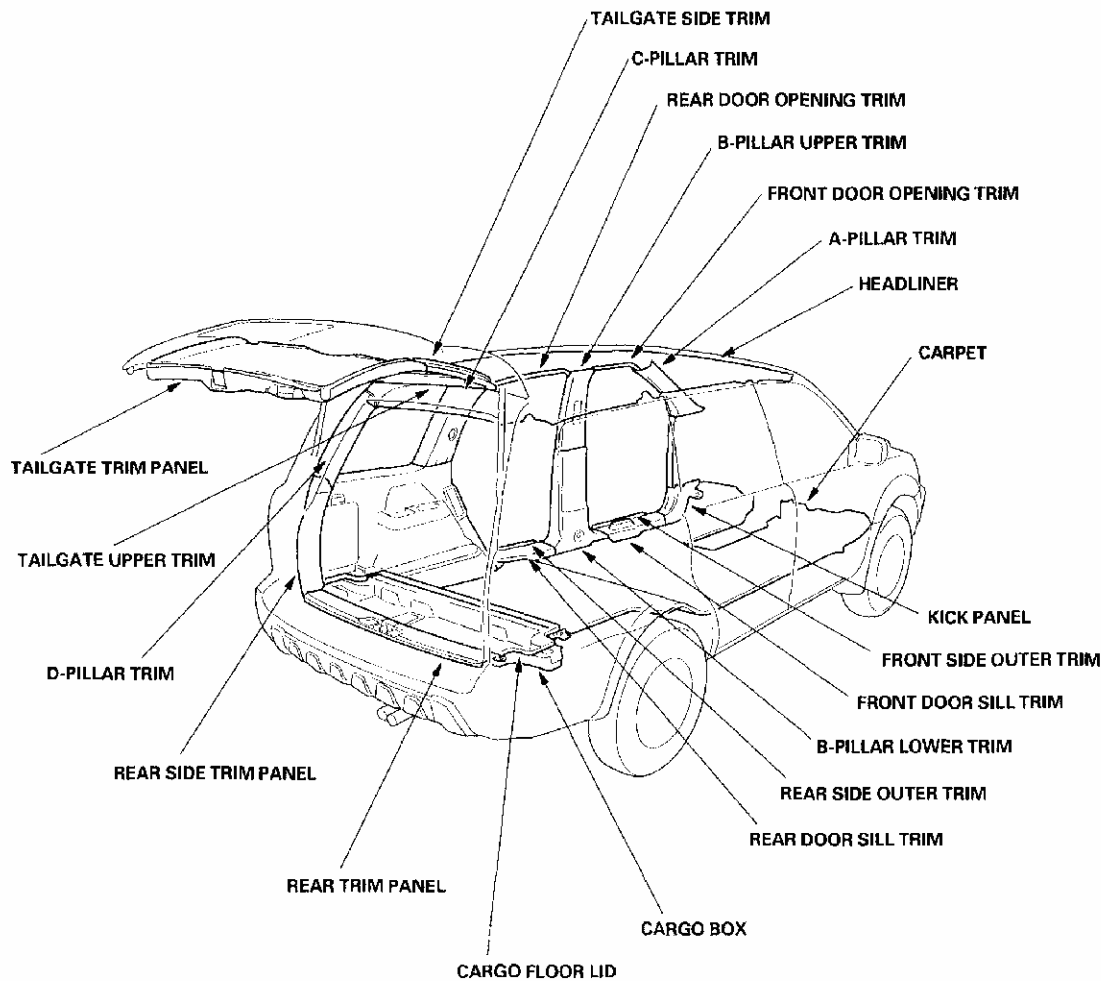

G01465428

Fig. 1: Locating Interior Trim Components
Courtesy of AMERICAN HONDA MOTOR CO., INC.

TRIM REMOVAL/INSTALLATION - DOOR AREA

NOTE:

- Put on gloves to protect your hands.
- When prying with a flat-tip screwdriver, wrap it with protective tape to prevent damage.
- Take care not to bend or scratch the trim and panels.

1. Remove the trim as shown.

2. Install the trim in the reverse order of removal, and note these items:

- Replace any damaged clips.
- Push the clips and hooks into place securely.
- Apply liquid thread lock to the anchor bolts before installation.
- Before installing the anchor bolts, make sure there are no twists or kinks in the seat belts.

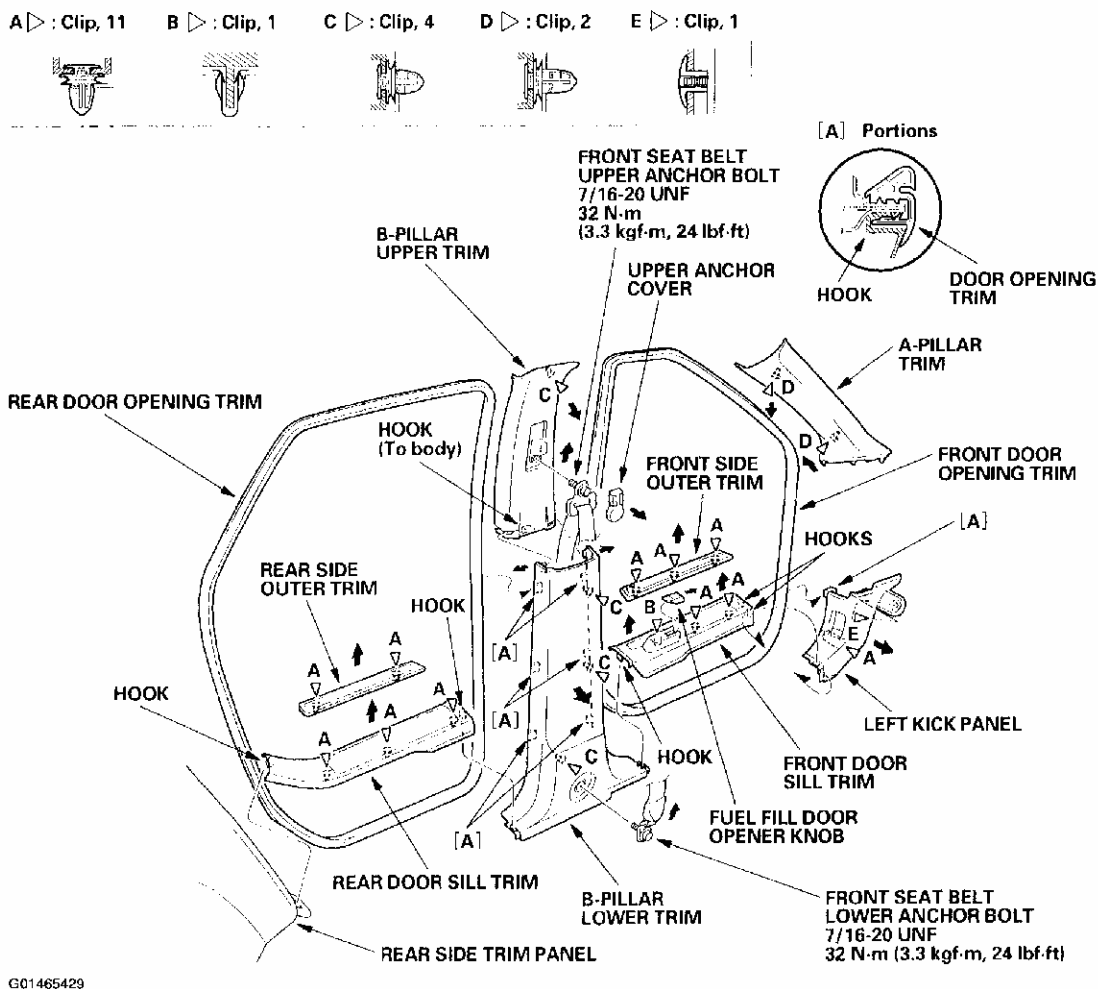

Fig. 2: Identifying Fastener Locations - Door Area
Courtesy of AMERICAN HONDA MOTOR CO., INC.

TRIM REMOVAL/INSTALLATION - REAR SIDE AREA

NOTE:

- Put on gloves to protect your hands.
- When prying with a flat-tip screwdriver, wrap it with protective tape to prevent damage.
- Take care not to bend or scratch the trim and panels.

1. Remove these items, then remove the trim in the sequence shown:
 - Rear door sill trim (see **TRIM REMOVAL/INSTALLATION - DOOR AREA**).
 - D-pillar trim (see **TRIM REMOVAL/INSTALLATION - REAR SIDE PILLAR AREA**).
 - Rear trim panel (see **TRIM REMOVAL/INSTALLATION - CARGO AREA**).
 - Third row seat (see **THIRD ROW SEAT REMOVAL/INSTALLATION**)
2. Install the trim in the reverse order of removal, and note these items:
 - Replace any damaged clips.
 - Push the clips and hooks into place securely.
 - Make sure there are no pinches in the belt.

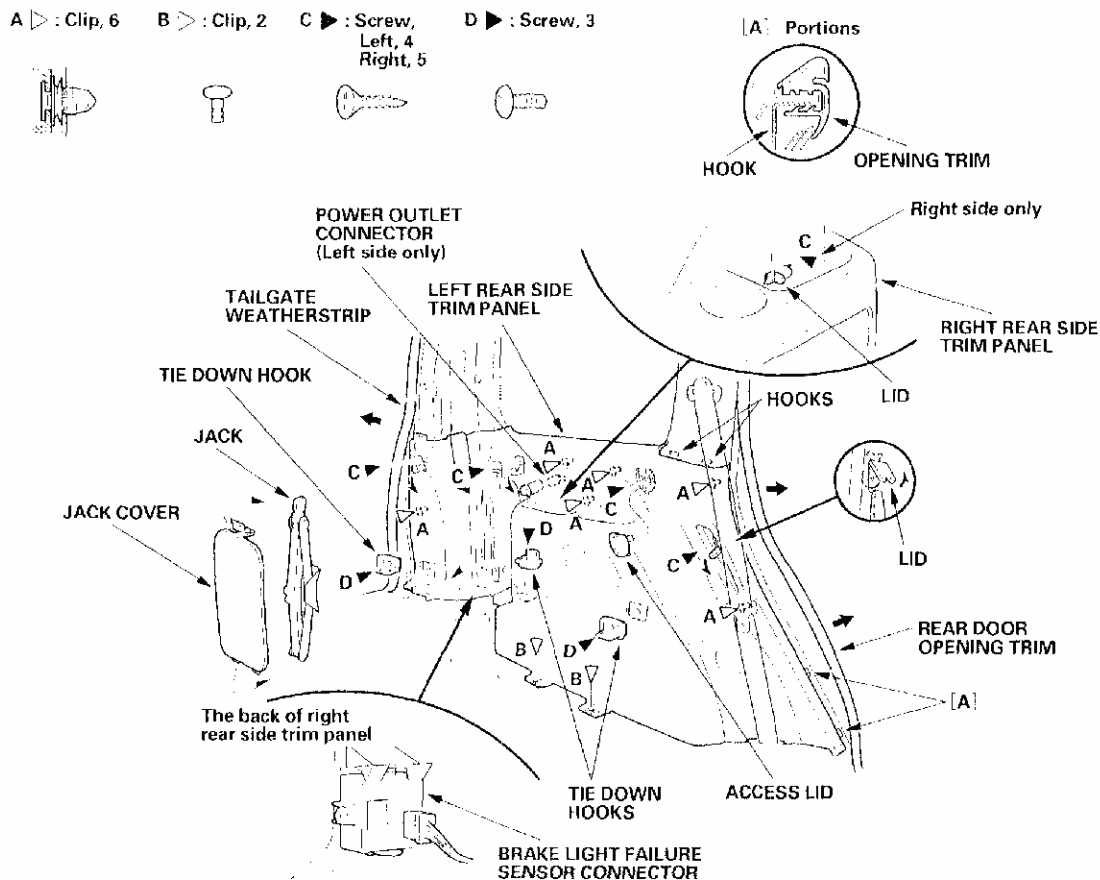

G01485430

Fig. 3: Identifying Fastener Locations - Rear Side Area
 Courtesy of AMERICAN HONDA MOTOR CO., INC.

TRIM REMOVAL/INSTALLATION - REAR SIDE PILLAR AREA

NOTE:

- Put on gloves to protect your hands.
- When prying with a flat-tip screwdriver, wrap it with protective tape to prevent damage.
- Take care not to bend or scratch the trim and panels.

1. Remove the trim as shown. To remove the C-pillar, trim, remove the upper portion of the rear side trim panel as necessary (see **TRIM REMOVAL/INSTALLATION - REAR SIDE AREA**).
2. Install the trim in the reverse order of removal, and note these items:
 - Replace any damaged clips.
 - Push the clips into place securely.
 - Apply liquid thread lock to the upper anchor bolts before installation.
 - When installing the rear side trim panel, make sure there are no pinches in the seat belts.
 - Before installing the anchor bolts, make sure there are no twists or kinks in the seat belts.

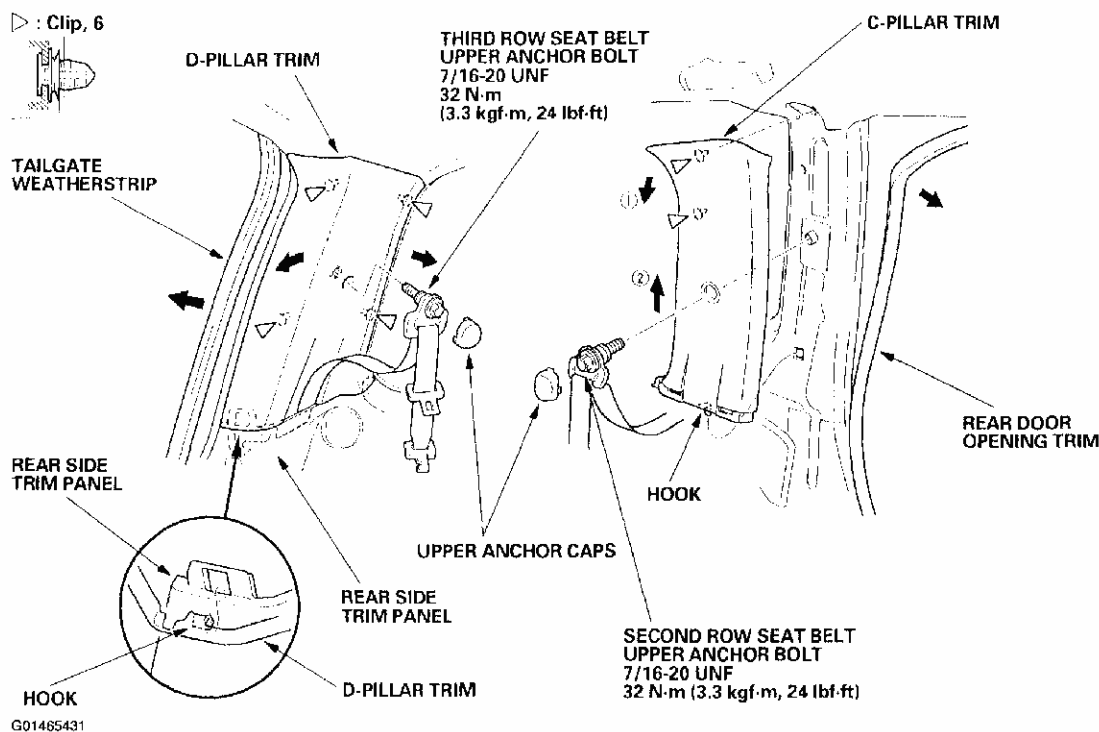

Fig. 4: Identifying Fastener Locations - Rear Side Pillar Area
 Courtesy of AMERICAN HONDA MOTOR CO., INC.

TRIM REMOVAL/INSTALLATION - CARGO AREA

NOTE:

- Put on gloves to protect your hands.
- When prying with a flat-tip screwdriver, wrap it with protective tape to prevent damage.
- Take care not to bend or scratch the trim and panels.

1. Remove the trim as shown. To remove the cargo box, remove both rear side trim panels (see **TRIM REMOVAL/INSTALLATION - REAR SIDE AREA**).
2. Install the trim in the reverse order of removal, and note these items:
 - Replace any damaged clips.
 - Push the clips into place securely.

▷ : Clip, 9

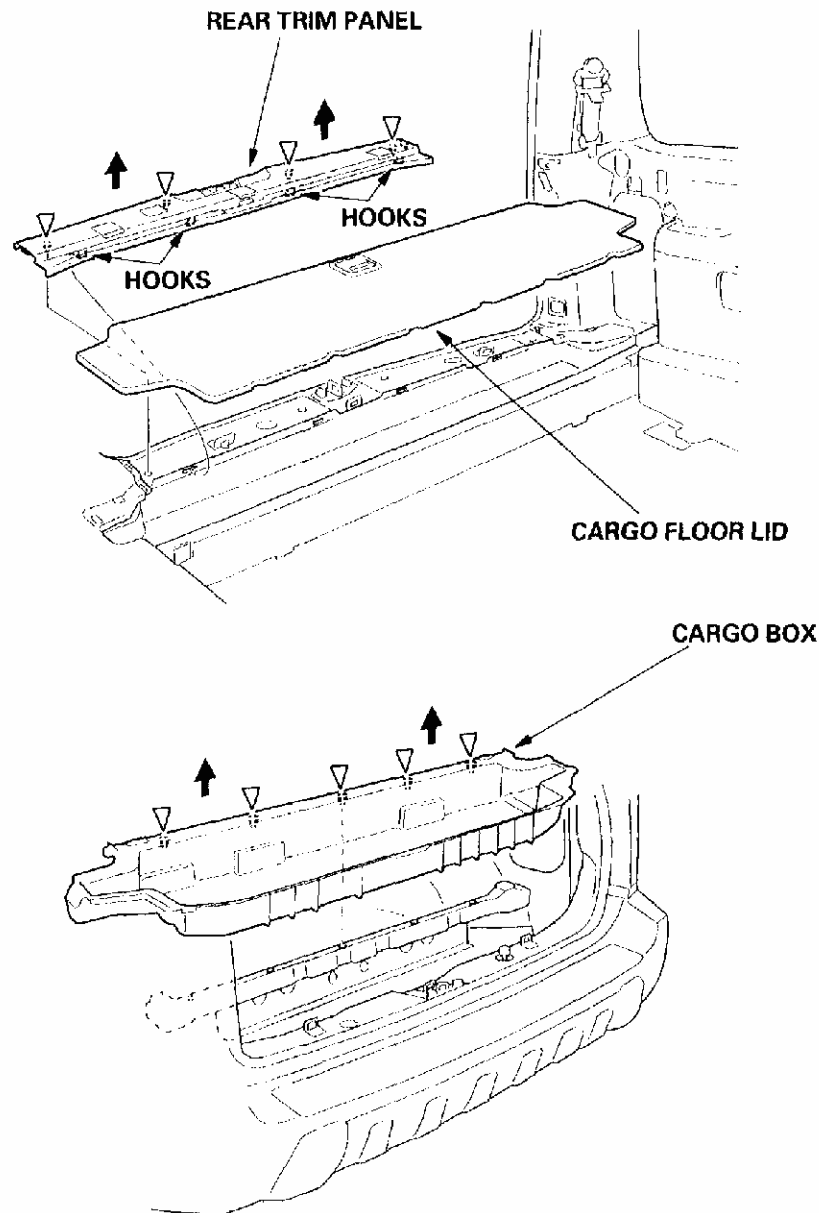

G01465432

Fig. 5: Identifying Fastener Locations - Cargo Area
Courtesy of AMERICAN HONDA MOTOR CO., INC.

TRIM REMOVAL/INSTALLATION - TAILGATE AREA

NOTE:

- Put on gloves to protect your hands.
- When prying with a flat-tip screwdriver, wrap it with protective tape to prevent damage.
- Take care not to bend or scratch the trim and panels.

1. Remove the trim in the sequence shown. To remove the tailgate trim panel, remove the cargo area light (see **TAILGATE LIGHT TEST**).
 - Tailgate Upper Trim
 - Left Tailgate Side Trim
 - Right Tailgate Side Trim
 - Tailgate Handle
 - Tailgate Trim Panel
2. Install the trim in the reverse order of removal, and note these items:
 - Replace any damaged clips.
 - Push the clips, hooks, and tabs into place securely.

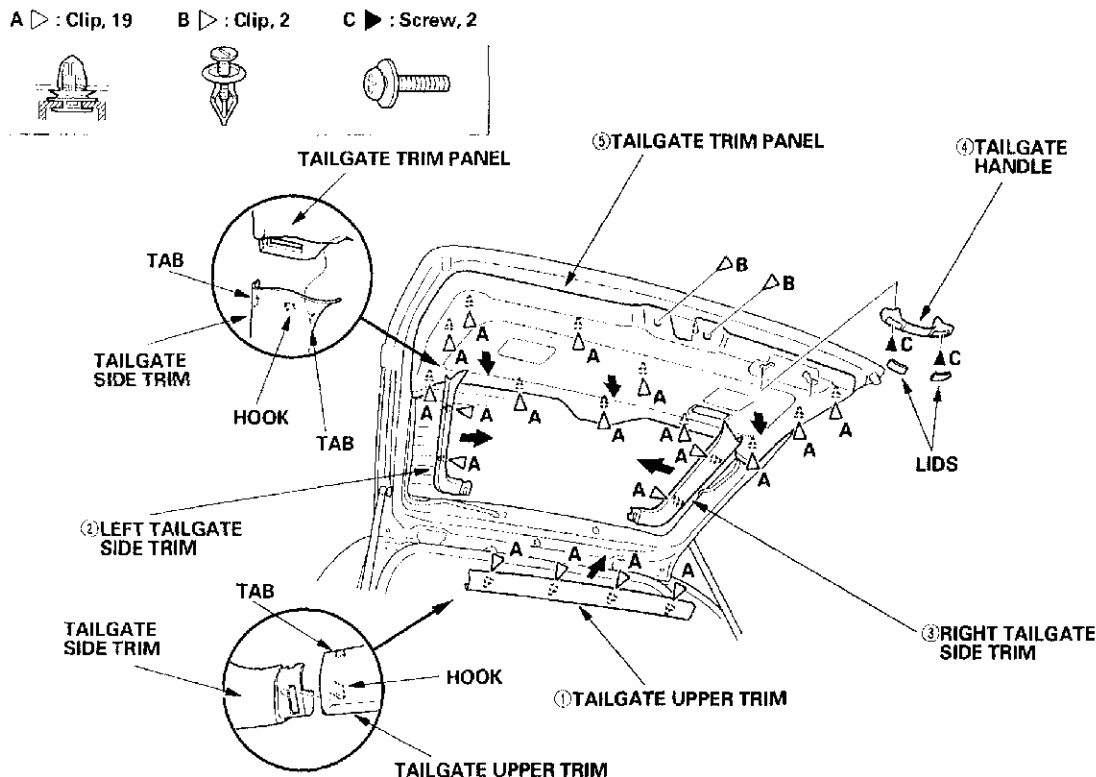

G01465433

Fig. 6: Identifying Fastener Locations - Tailgate Area
 Courtesy of AMERICAN HONDA MOTOR CO., INC.

HEADLINER REMOVAL/INSTALLATION

NOTE:

- When prying with a flat-tip screwdriver, wrap it with protective tape to prevent damage.
- Take care not to bend and scratch the headliner.

- **Be careful not to damage the dashboard and other interior trim pieces.**

1. Remove these items:

- A-pillar trim, both sides (see **TRIM REMOVAL/INSTALLATION - DOOR AREA**).
- B-pillar lower trim, upper portion of both sides (see **TRIM REMOVAL/INSTALLATION - DOOR AREA**).
- D-pillar trim, both sides (see **TRIM REMOVAL/INSTALLATION - REAR SIDE PILLAR AREA**).
- Rear side trim panel, upper portion of both sides (see **TRIM REMOVAL/INSTALLATION - REAR SIDE AREA**).
- C-pillar trim, both sides (see **TRIM REMOVAL/INSTALLATION - REAR SIDE PILLAR AREA**).

2. Release the tabs (A) on both sides with a flat-tip screwdriver, then remove the sunvisor cap (B) from the bracket (C). Turn the cap, and remove it.

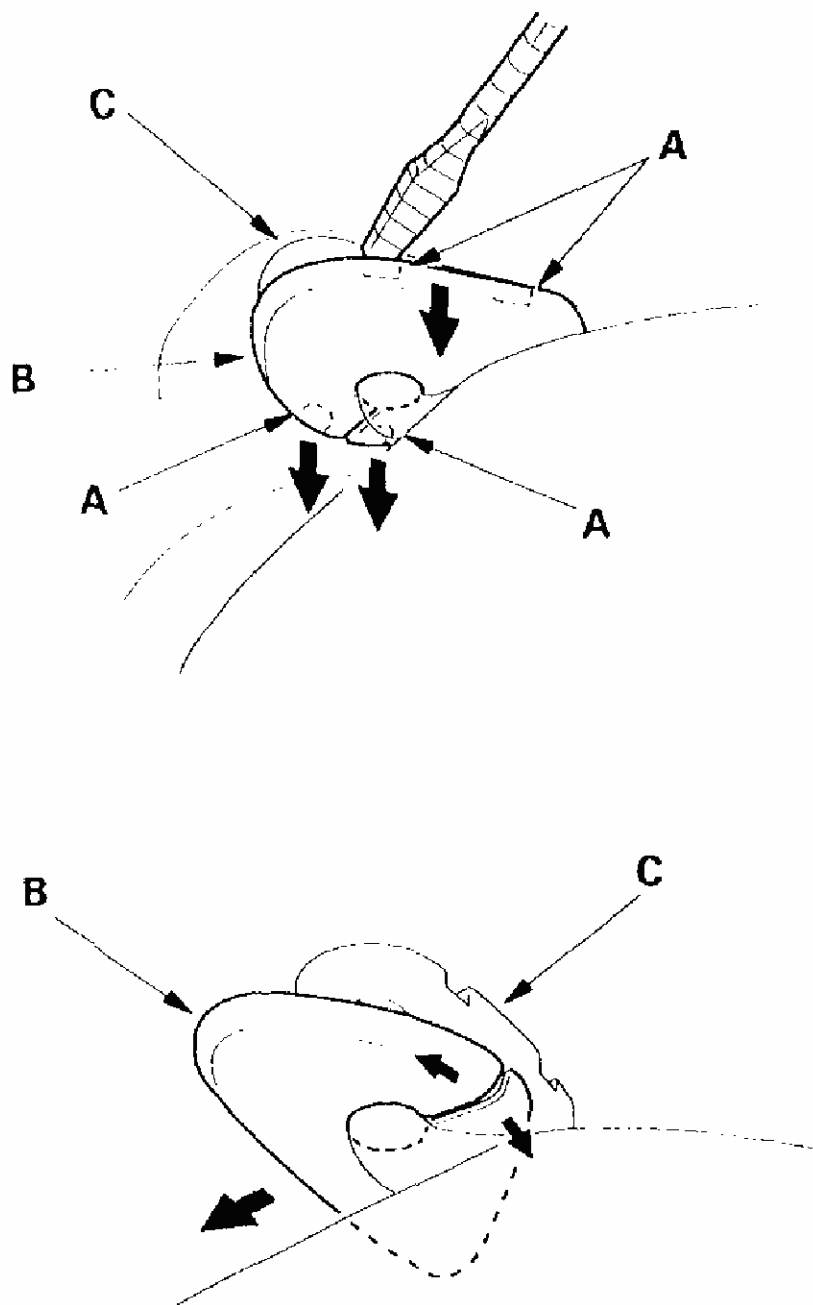

G01465434

Fig. 7: Releasing The Tabs & Removing The Sunvisor Cap From The Bracket
Courtesy of AMERICAN HONDA MOTOR CO., INC.

3. Remove the sunvisor (A) and holder (B) from both sides.
 - A. Remove the self-tapping ET screws.
 - B. Remove the sunvisor from the body and holder.

- C. Disconnect the vanity mirror light connector (C).
- D. Using a flat-tip screwdriver, push the hook (D), and turn the holder 90°, then pull it out.

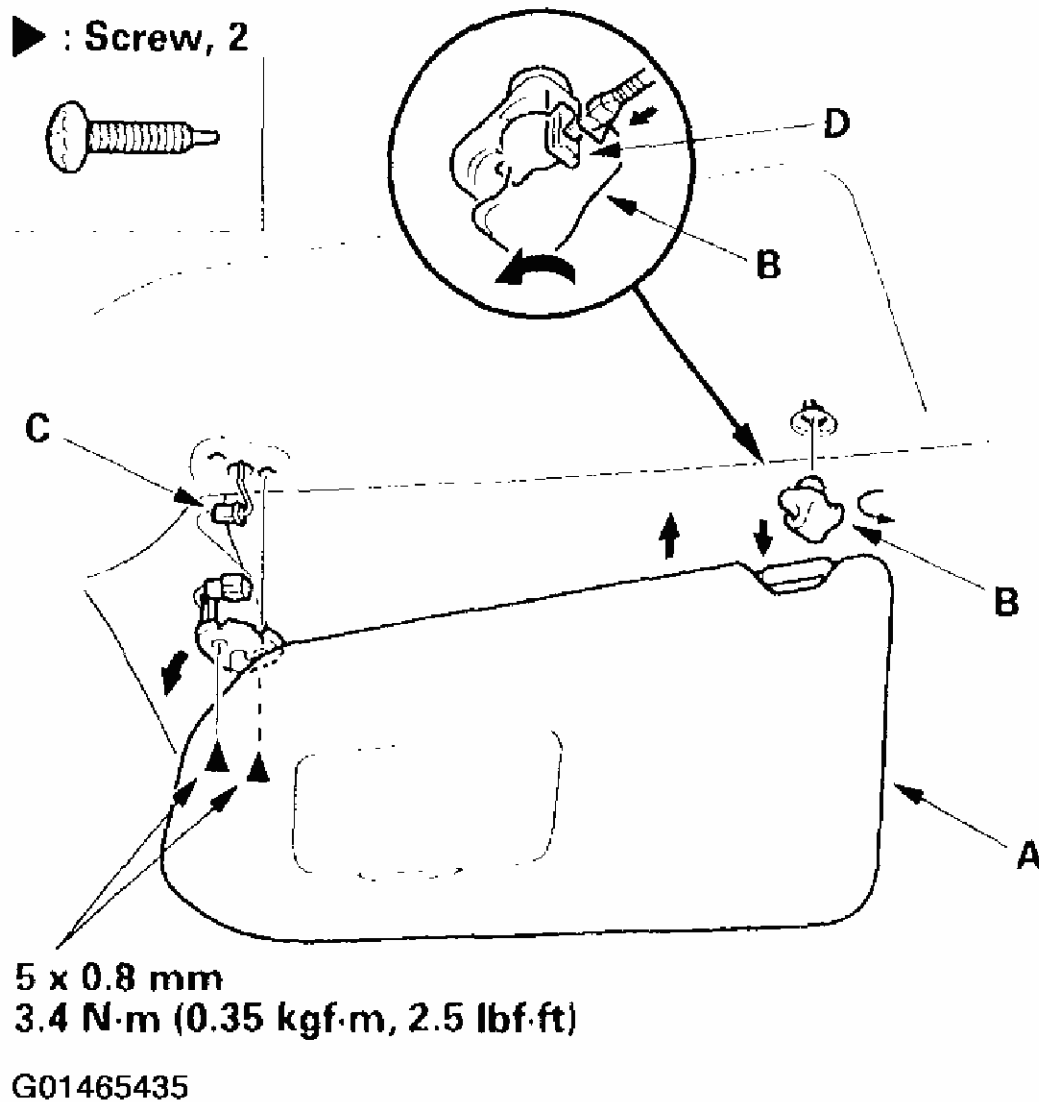
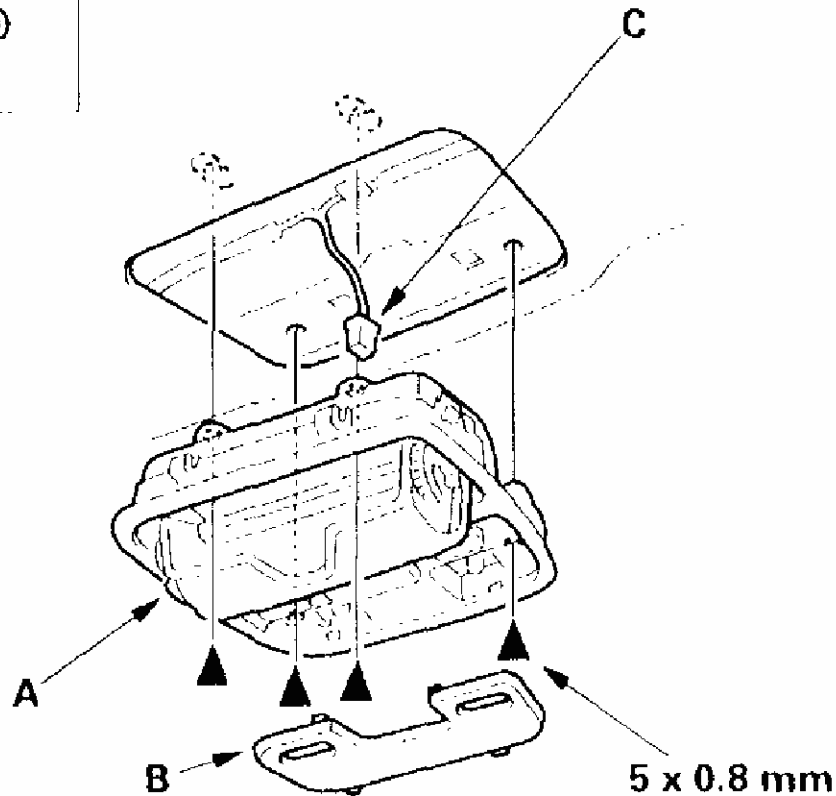

Fig. 8: Identifying Headliner Fastener Locations (1 Of 8)
Courtesy of AMERICAN HONDA MOTOR CO., INC.

- 4. Remove the roof console (A).
 - A. Remove the lens (B).
 - B. Remove the screws.
 - C. Pull out the roof console, and disconnect the front individual map light connector

(C).

►: Screw, 4



G01465436

Fig. 9: Identifying Headliner Fastener Locations (2 Of 8)
Courtesy of AMERICAN HONDA MOTOR CO., INC.

5. Remove the caps (A), and remove the screws, then remove the grab handles (B) driver's and front passenger's).

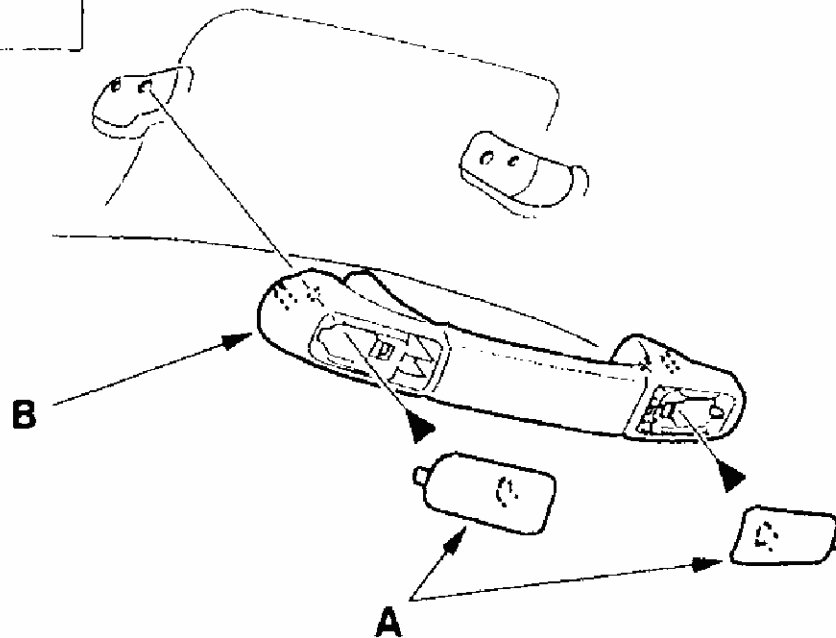
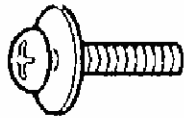
► : Screw, 2

G01465437

Fig. 10: Identifying Headliner Fastener Locations (3 Of 8)**Courtesy of AMERICAN HONDA MOTOR CO., INC.**

6. Remove the cap (A) and interior light lens (B), and remove the screws, then remove the grab handles (C). Disconnect the interior light connector (D) (second and third row passenger's).

► : Screw, 2

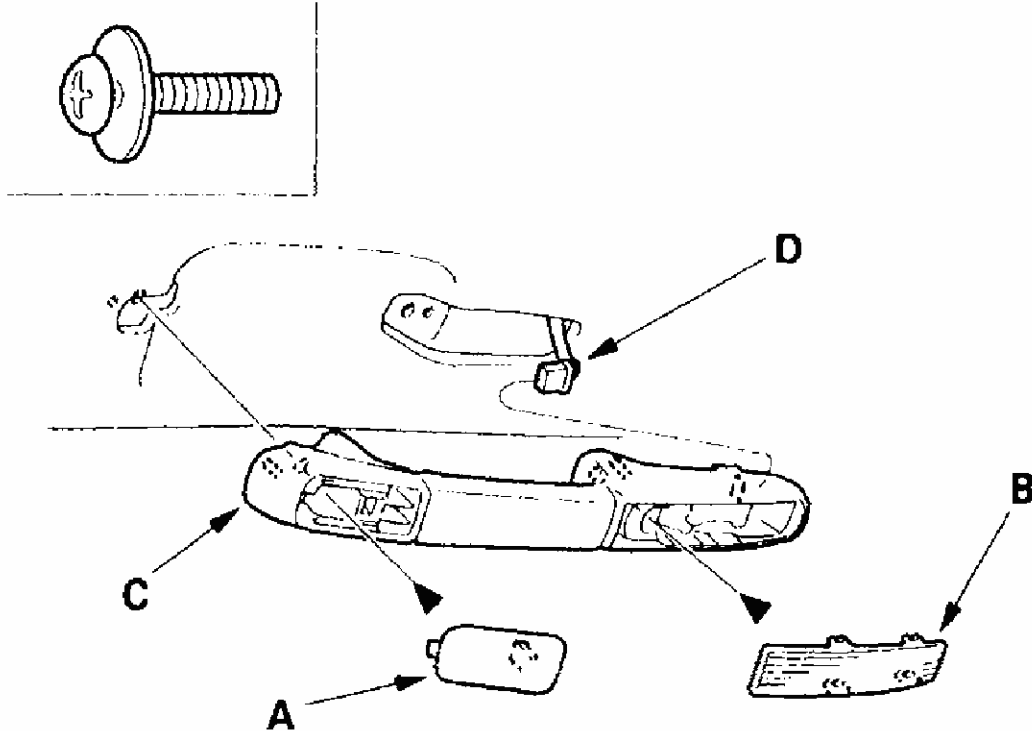

G01465438

Fig. 11: Identifying Headliner Fastener Locations (4 Of 8)
Courtesy of AMERICAN HONDA MOTOR CO., INC.

7. With rear entertainment system: Remove the display cover (see **REAR CONTROLLER AND SCREEN REMOVAL/INSTALLATION**).
8. Pull the center second row seat belt cover (A) down to detach the clips, then remove it. Remove the seat belt (B) through the hole in the cover.

▷ : Clip, 3

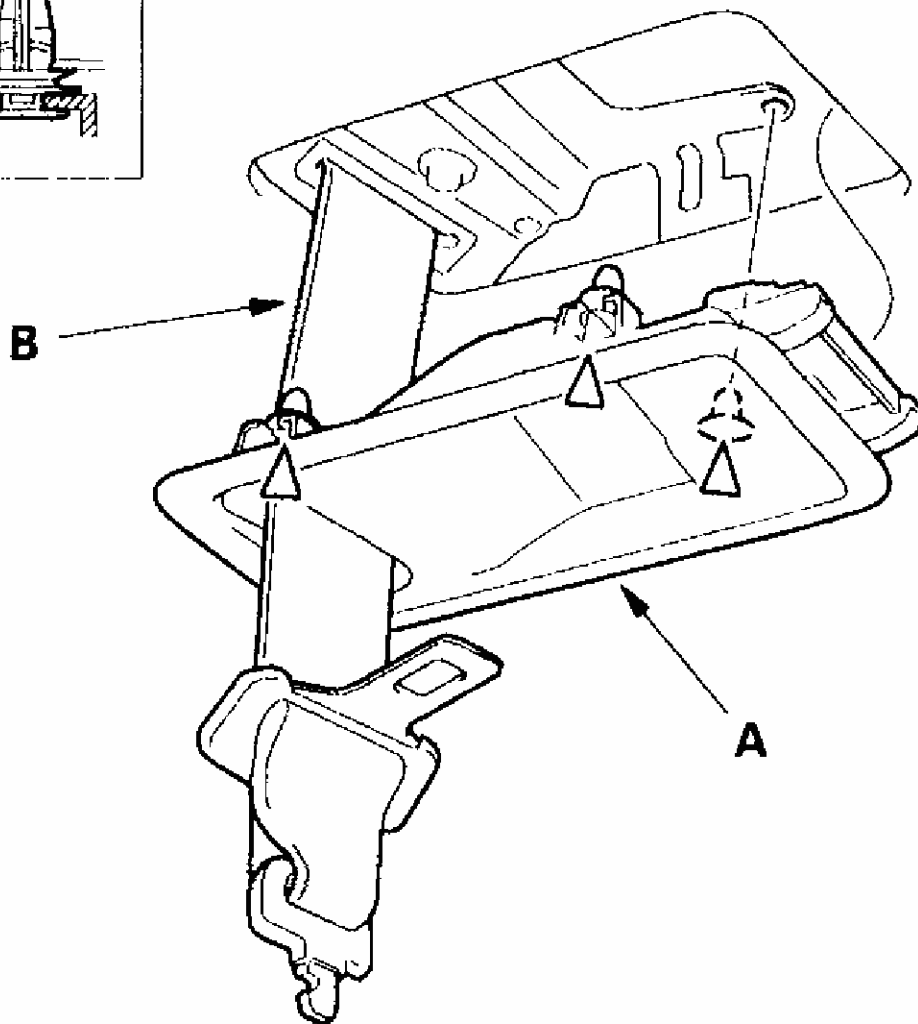
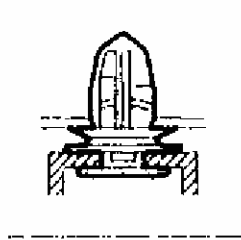

G01465439

Fig. 12: Identifying Headliner Fastener Locations (5 Of 8)
Courtesy of AMERICAN HONDA MOTOR CO., INC.

9. Pull the center third row seat belt cover (A) down to detach the clips, then remove it.

▷ : Clip, 4

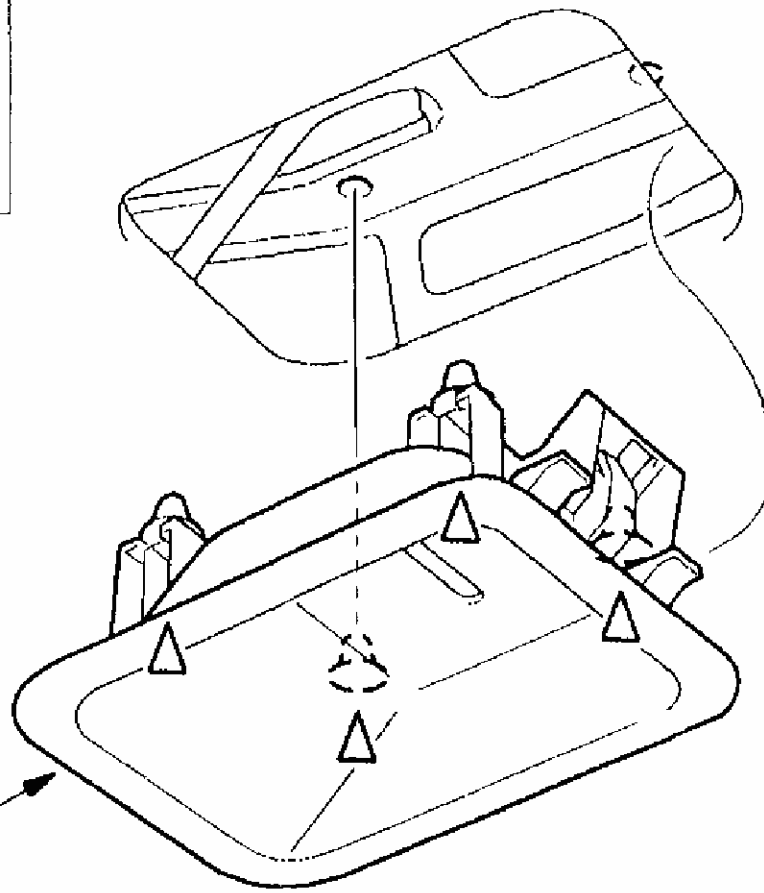
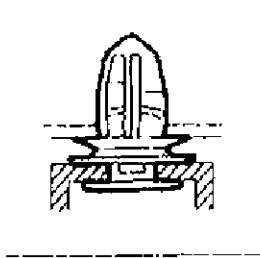

G01465440

Fig. 13: Identifying Headliner Fastener Locations (6 Of 8)
Courtesy of AMERICAN HONDA MOTOR CO., INC.

10. Detach the hooks (A), then remove the seat belt guide (B), and remove the center third row seat belt (C) through the hole in the guide.

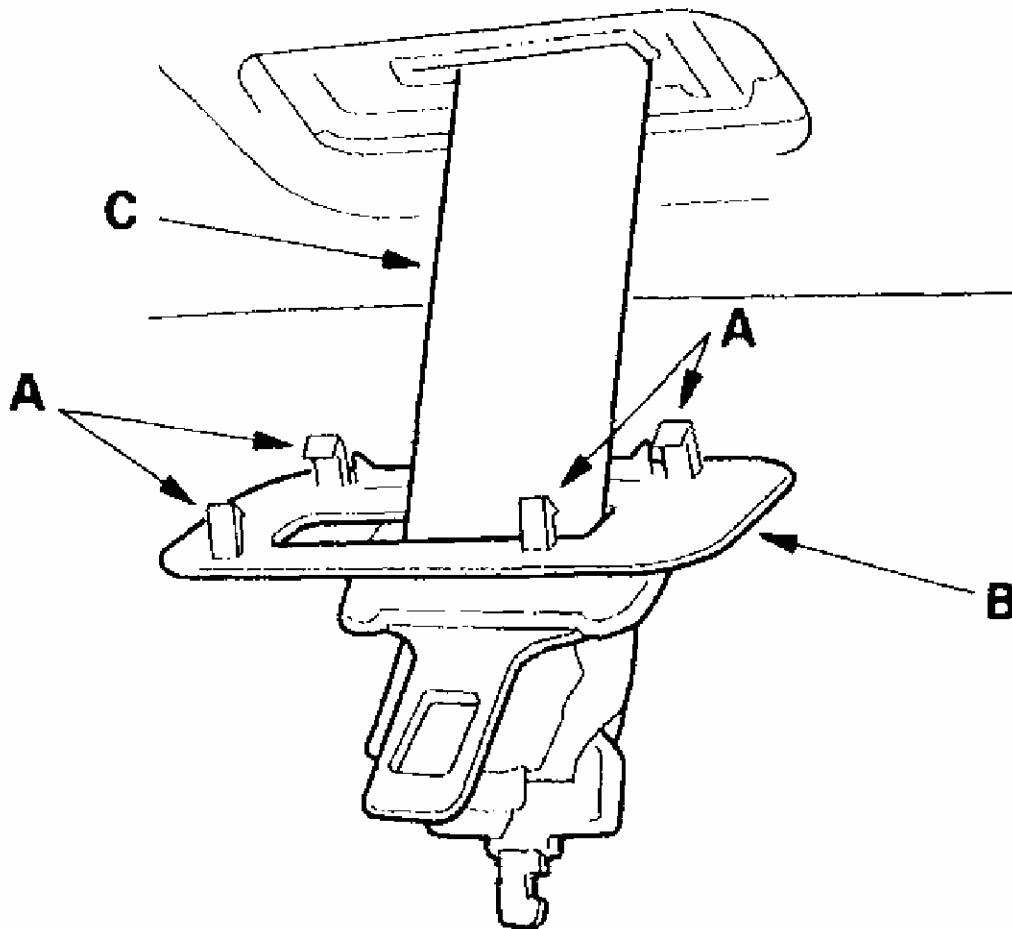

G01465441

Fig. 14: Detaching The Hooks, & Removing The Seat Belt Guide & The Center Third Row Seat Belt

Courtesy of AMERICAN HONDA MOTOR CO., INC.

11. With the help of an assistant, remove the headliner (A).
 - A. Remove the roof portion of the tailgate weatherstrip (B).
 - B. Pull the rear edge of the headliner down to detach the clips.
 - C. Remove the remaining front door opening trim (C) and rear door opening trim (D) from each opening.
 - D. Lower the headliner.

▷ : Clip, 2

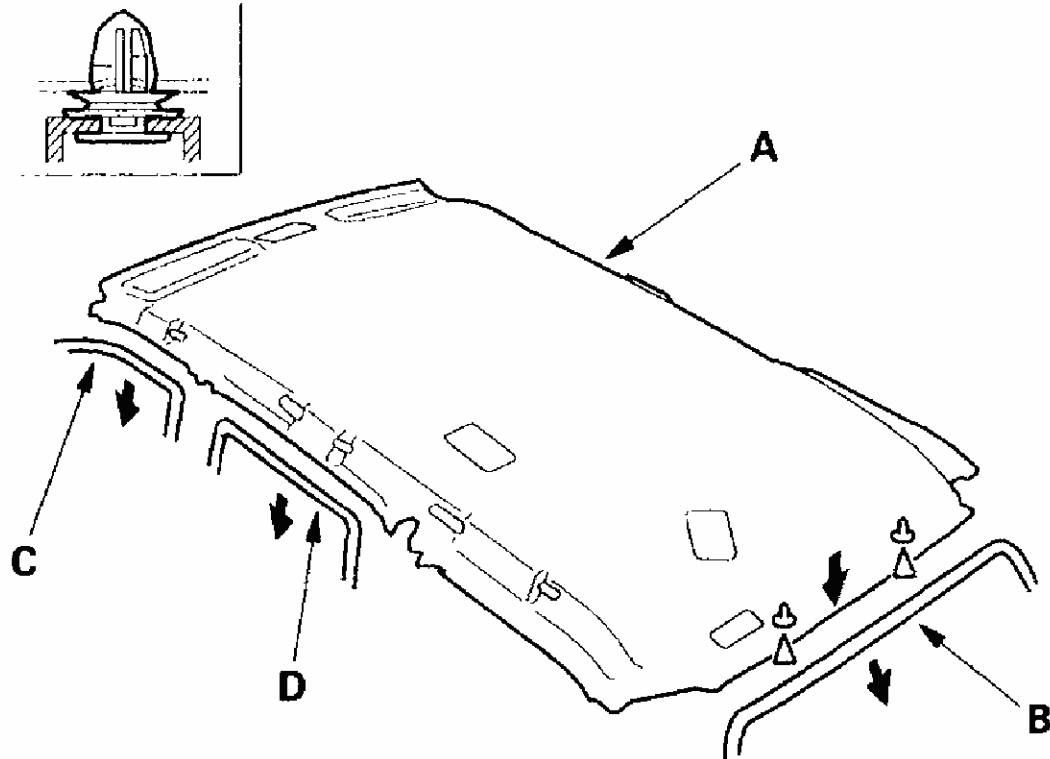

G01465442

Fig. 15: Identifying Headliner Fastener Locations (7 Of 8)
Courtesy of AMERICAN HONDA MOTOR CO., INC.

12. Remove the headliner through the tailgate opening. Take care not to damage the headliner.
13. Using a clip remover, detach the clips (E, F), then remove the roof side pads (A, B, C, D).

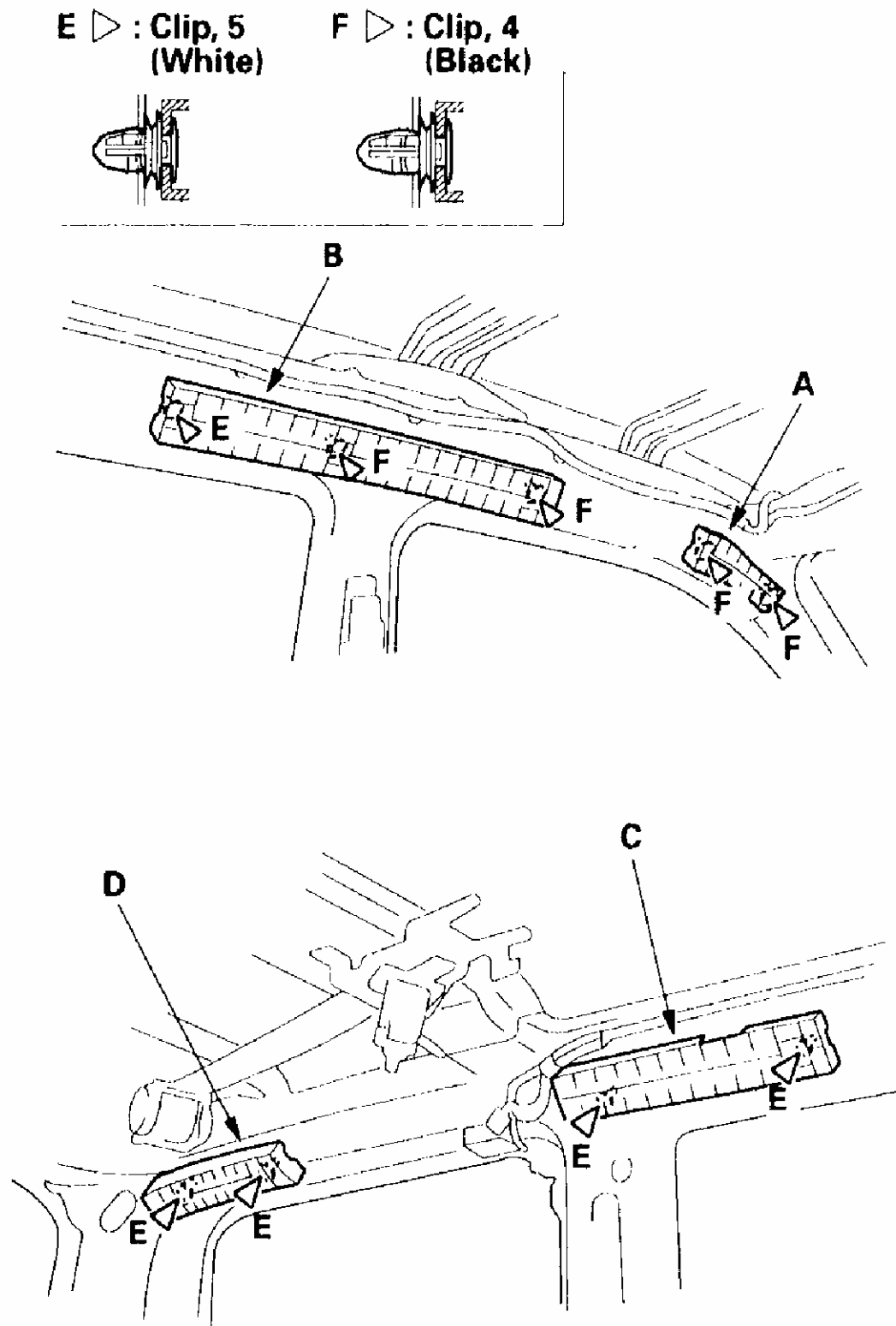

G01465443

Fig. 16: Identifying Headliner Fastener Locations (8 Of 8)

Courtesy of AMERICAN HONDA MOTOR CO., INC.

14. Install the headliner in the reverse order of removal and note these items:

- Replace any damaged clips.
- When reinstalling the headliner through the tailgate opening, be careful not to fold or bend it. Also, be careful not to scratch the body.
- Hold the headliner in place with the grab handles installed loosely, then install the center second row seat belt cover. This will center the headliner front to rear.
- Push the clips and tabs into place securely.
- If the threads on a visor mounting ET screws are worn out, use an oversized ET screw (P/N 90137-S30-0030) made specifically for this application.
- Check that both sides of the headliner are securely attached to the trim.

CARPET REPLACEMENT

SRS components are located in this area. Review the SRS components locations, precautions and procedures before performing repairs or service. For 2004 models, see **AIR BAG RESTRAINT SYSTEMS** . For 2003 models, see **AIR BAG RESTRAINT SYSTEMS** .

NOTE:

- Put on gloves to protect your hands.
- Take care not to damage, wrinkle or twist the carpet.
- Be careful not to damage the dashboard or other interior trim pieces.

1. Remove these items:

- Front seats, both sides (see **FRONT SEAT REMOVAL/INSTALLATION**)
- Second row seats, both sides (see **SECOND ROW SEAT REMOVAL/INSTALLATION**)
- Third row seats both sides (see **THIRD ROW SEAT REMOVAL/INSTALLATION**)
- Kick panels, both sides (see **TRIM REMOVAL/INSTALLATION - DOOR AREA**).
- B-pillar lower trim, both sides (see **TRIM REMOVAL/INSTALLATION - DOOR AREA**).
- Console side trim, both sides (see setup 4 on **CENTER CONSOLE REMOVAL/INSTALLATION**).
- Console rear trim (see step 5 on **CENTER CONSOLE REMOVAL/INSTALLATION**).

2. Remove the carpet (A).

- A. Release the fastener (B), then pull back the carpet from under the dashboard and center console (C).
- B. Pull out the carpet from under both rear side trim panels (D).

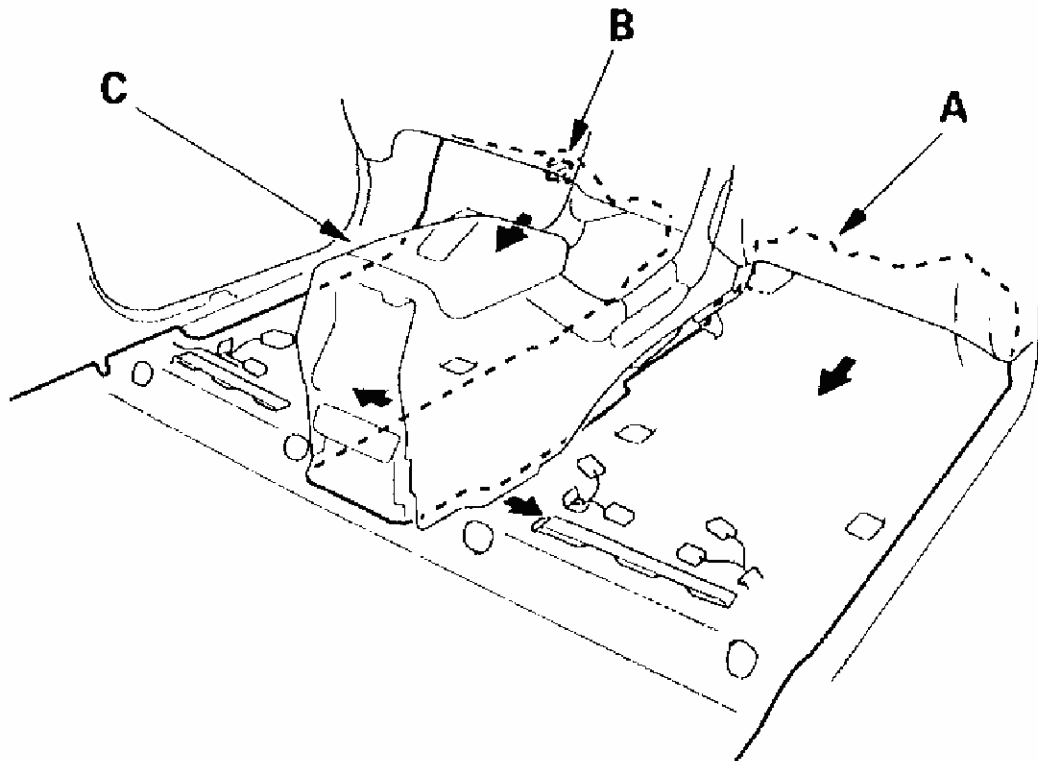

G01465444

Fig. 17: Removing The Carpet (1 Of 2)

Courtesy of AMERICAN HONDA MOTOR CO., INC.

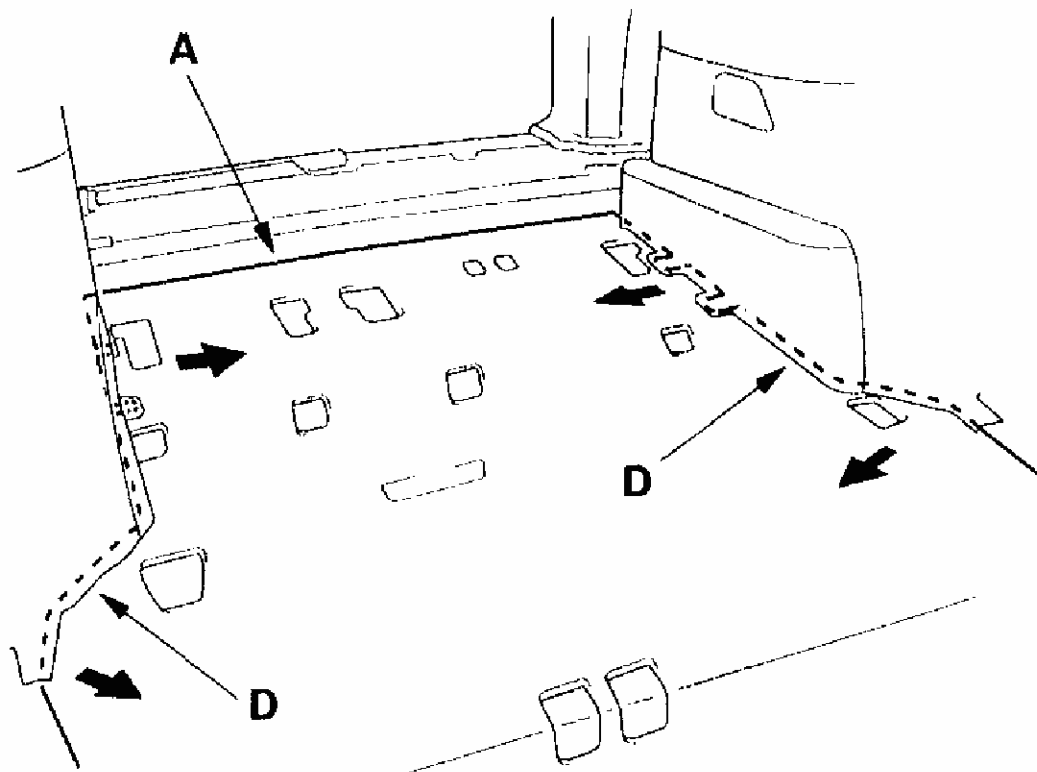

G01465445

Fig. 18: Removing The Carpet (2 Of 2)

Courtesy of AMERICAN HONDA MOTOR CO., INC.

3. Install the carpet in the reverse order of removal, and note these items:
 - Take care not to damage, wrinkle or twist the carpet.
 - Make sure the seat harnesses are routed correctly.
 - Slip the carpet under both rear side trim panel and center console properly.

CONSOLES

CENTER CONSOLE REMOVAL/INSTALLATION

NOTE:

- When prying with a flat-tip screwdriver, wrap it with protective tape, and apply protective tape around the related parts to prevent damage.
- Take care not to scratch the front seat, dashboard, and related parts.

1. Starting at the top, gently pull the center front covers (A) out to detach the clips (B), then pull the cover out to detach the remaining clips (C), and remove the covers from both sides.

B, C : Clip, 6

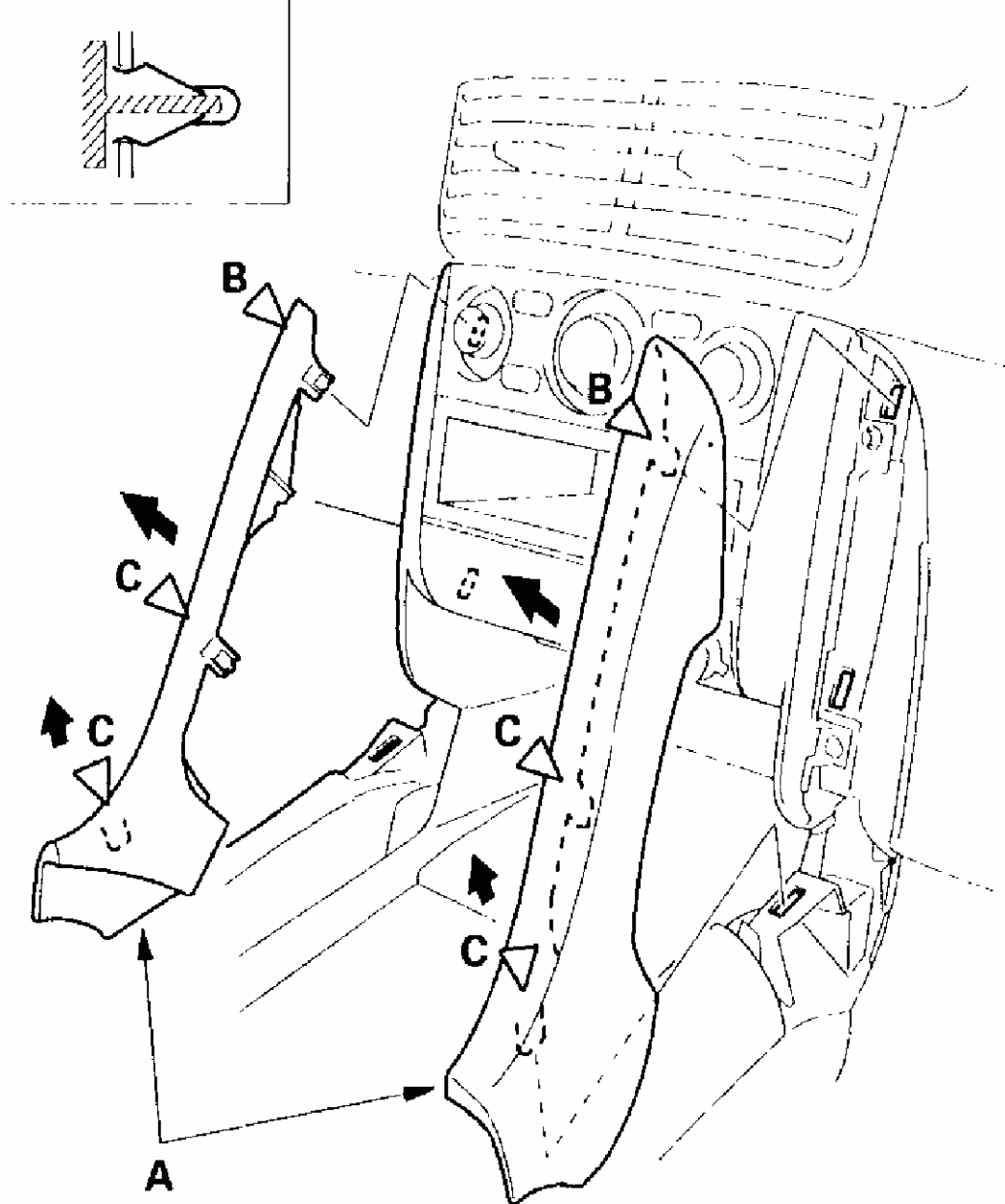

G01465446

Fig. 19: Identifying Center Console Fastener Locations (1 Of 6)
Courtesy of AMERICAN HONDA MOTOR CO., INC.

2. Remove the center lower cover (A).
 - A. Remove the coin pocket (B).
 - B. Remove the screws (C).
 - C. Pull the cover out to detach the clips (D).
 - D. Disconnect the accessory power socket connector (E) and console light connector (F).

C ► : Screw, 5 D ► : Clip, 2

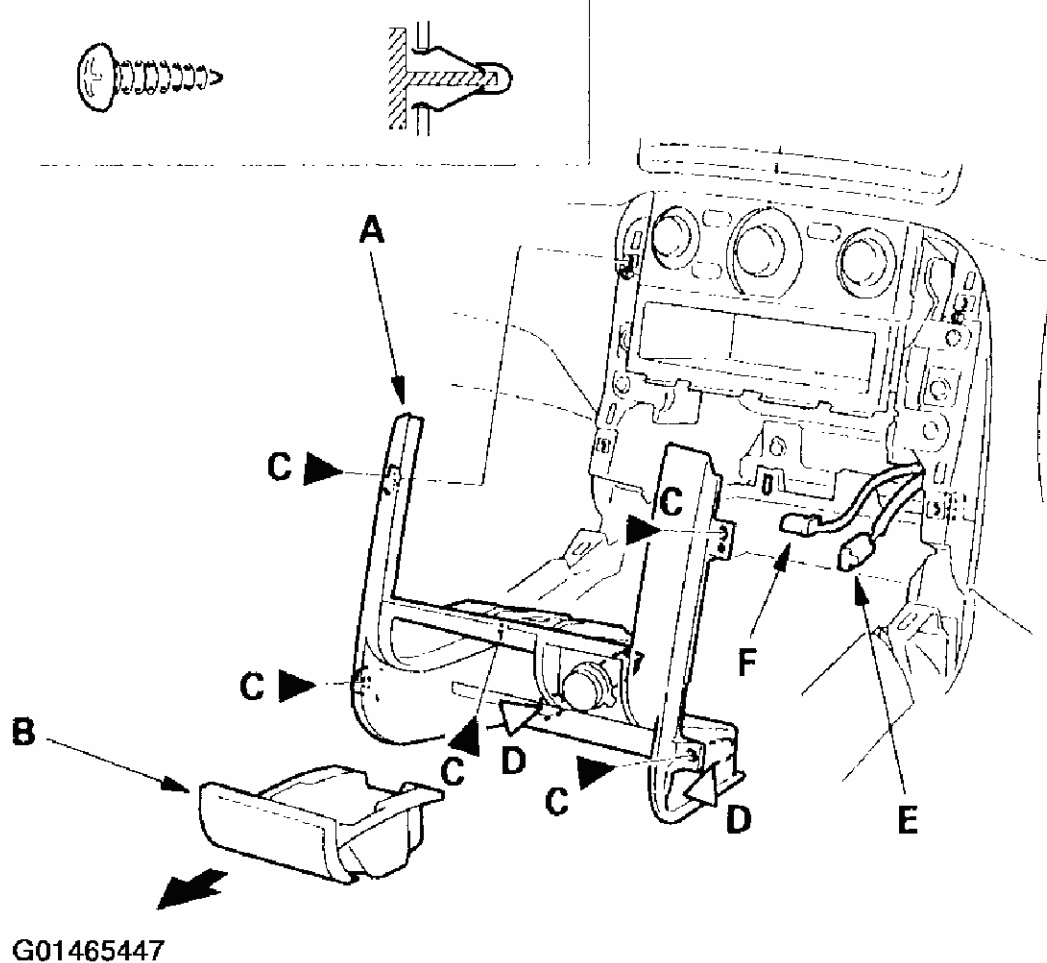
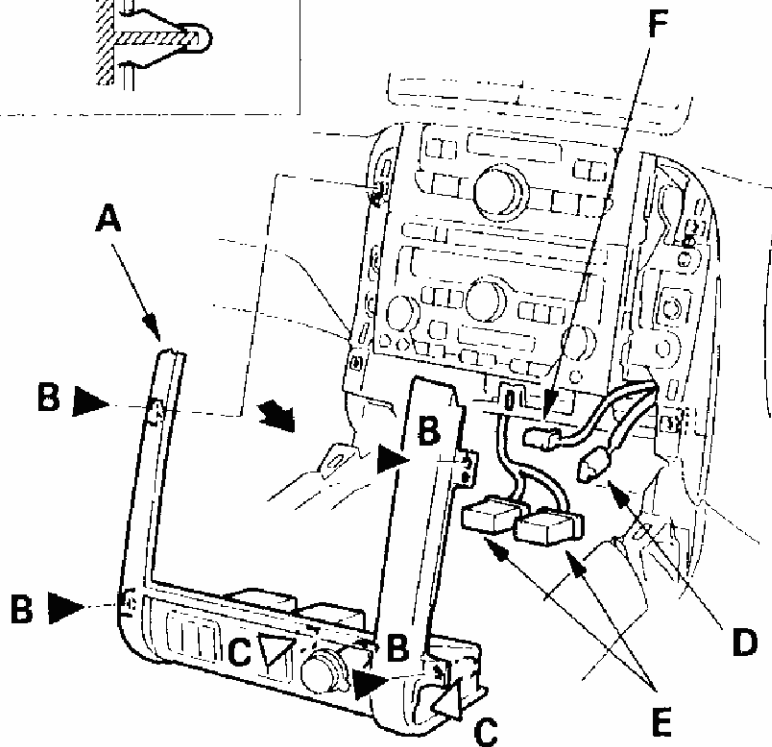
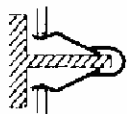

Fig. 20: Identifying Center Console Fastener Locations (2 Of 6)
 Courtesy of AMERICAN HONDA MOTOR CO., INC.

3. For some models: Remove the center lower cover (A) with the seat heater switches.
 - A. Remove the screws (B).
 - B. Pull the cover out to detach the clips (C).

- C. Disconnect the accessory power socket connector (D), seat heater switch connectors (E), and console light connector (F).

B ▶ : Screw, 4 C ▶ : Clip, 2



G01465448

Fig. 21: Identifying Center Console Fastener Locations (3 Of 6)
 Courtesy of AMERICAN HONDA MOTOR CO., INC.

4. Detach the clips and release the hooks (A), then remove the driver's console side trim (B) and passenger's console side trim (C).

▷ : **Clip, 14**

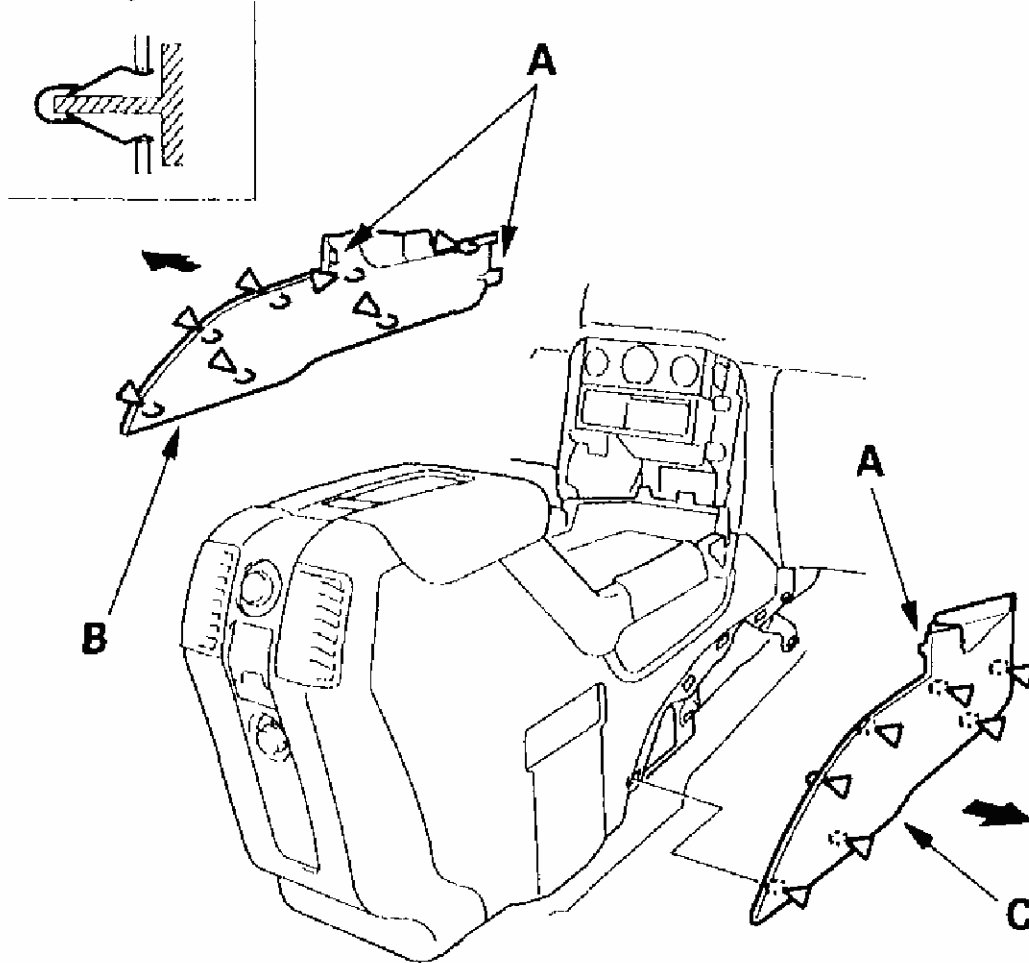

G01465449

Fig. 22: Identifying Center Console Fastener Locations (4 Of 6)
Courtesy of AMERICAN HONDA MOTOR CO., INC.

5. Starting at the top, gently pull out the console rear trim (A) to detach the clips (B), then pull out the trim to detach the remaining clips (C), and disconnect the rear heater-A/C passenger's control panel-unit connectors (D) and accessory power socket connector (E). If equipped with rear entertainment system, disconnect the rear entertainment system jack connector (F).

B, C ▷ : Clip, 9

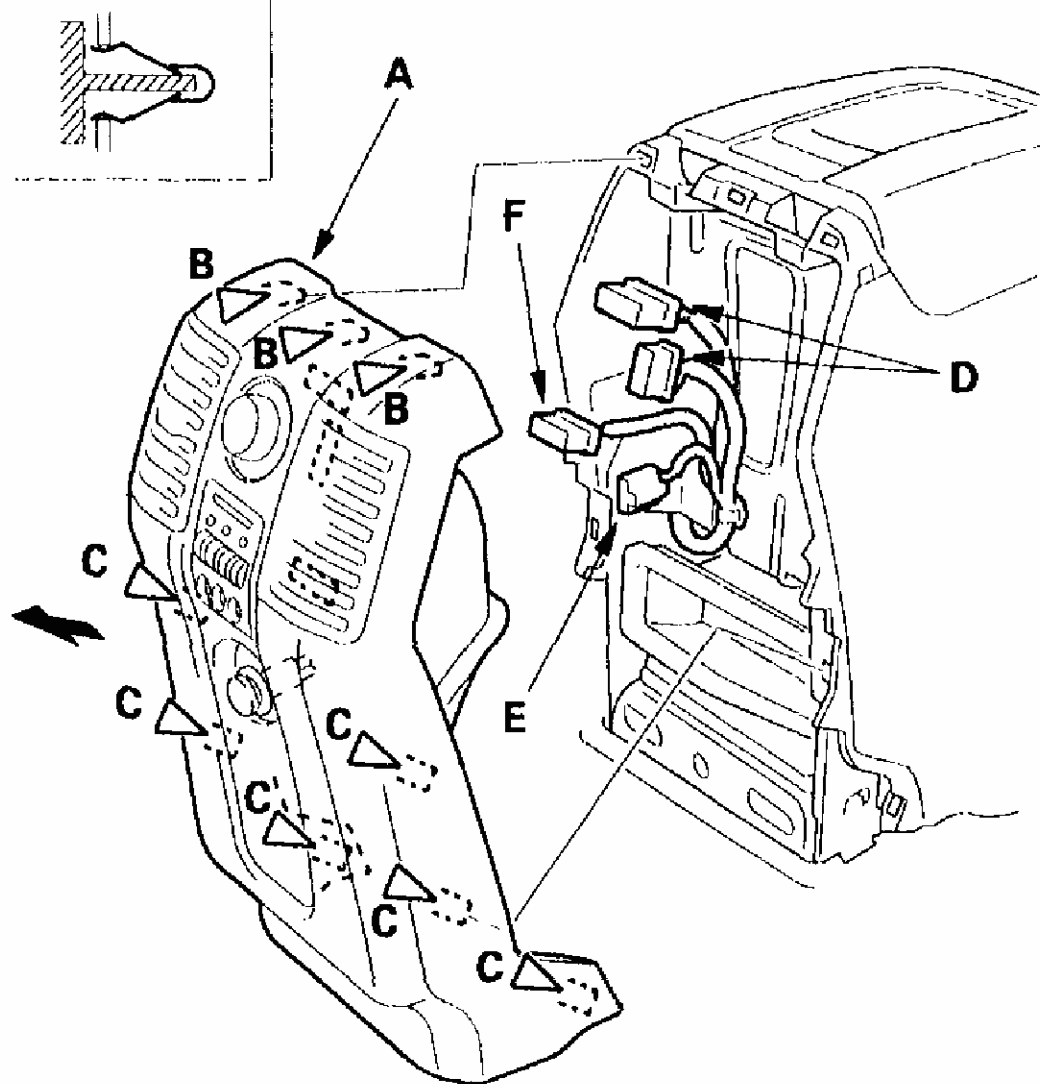

G01465450

Fig. 23: Identifying Center Console Fastener Locations (5 Of 6)
 Courtesy of AMERICAN HONDA MOTOR CO., INC.

6. Remove the center console (A).
 - A. From both sides, remove the bolts (B) and screws (C).
 - B. Detach the harness clip (D).
 - C. Disconnect the accessory power socket connector (E), and detach it.
 - D. Lift the console up, then remove it.

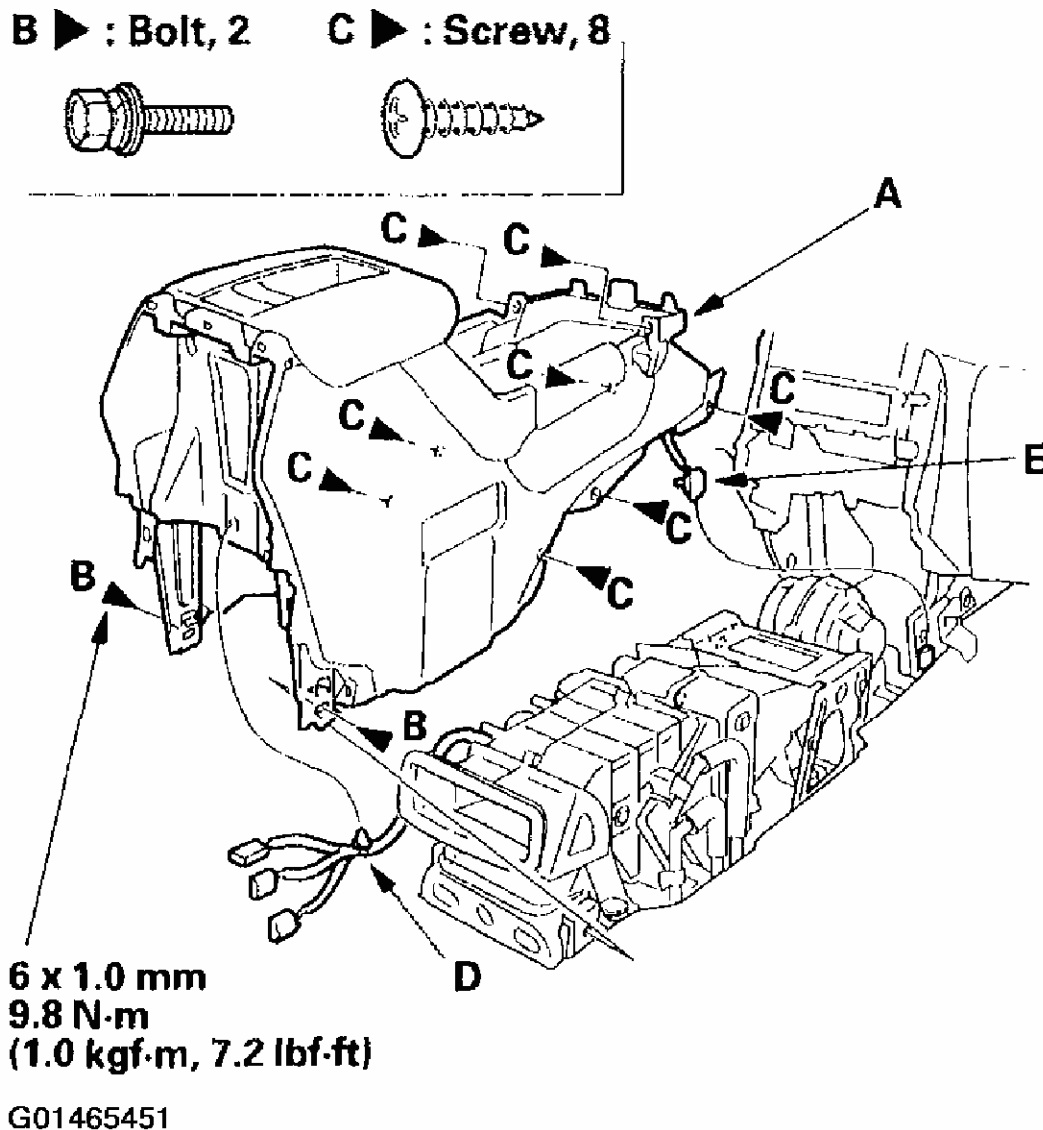

Fig. 24: Identifying Center Console Fastener Locations (6 Of 6)
 Courtesy of AMERICAN HONDA MOTOR CO., INC.

7. Install the center console in the reverse order of removal, and note these items:
 - Replace any damaged clips.
 - Make sure all the connectors are plugged in properly.
 - Push the clips into place securely.

DASHBOARD

INSTRUMENT PANEL REMOVAL/INSTALLATION

NOTE:

- When prying with a flat-tip screwdriver, wrap it with protective tape, and apply protective tape around the related parts to prevent damage.
- Take care not to scratch the dashboard and related parts.

1. Tilt the steering column down.
2. Remove the instrument panel (A).
 - A. Remove the screws (B).
 - B. Gently pull out the panel to release the clips (C) and hooks (D).
 - C. Release the bottom portion (E) of the panel from the steering column upper cover (F).

B ► : Screw, 2 C ► : Clip, 2

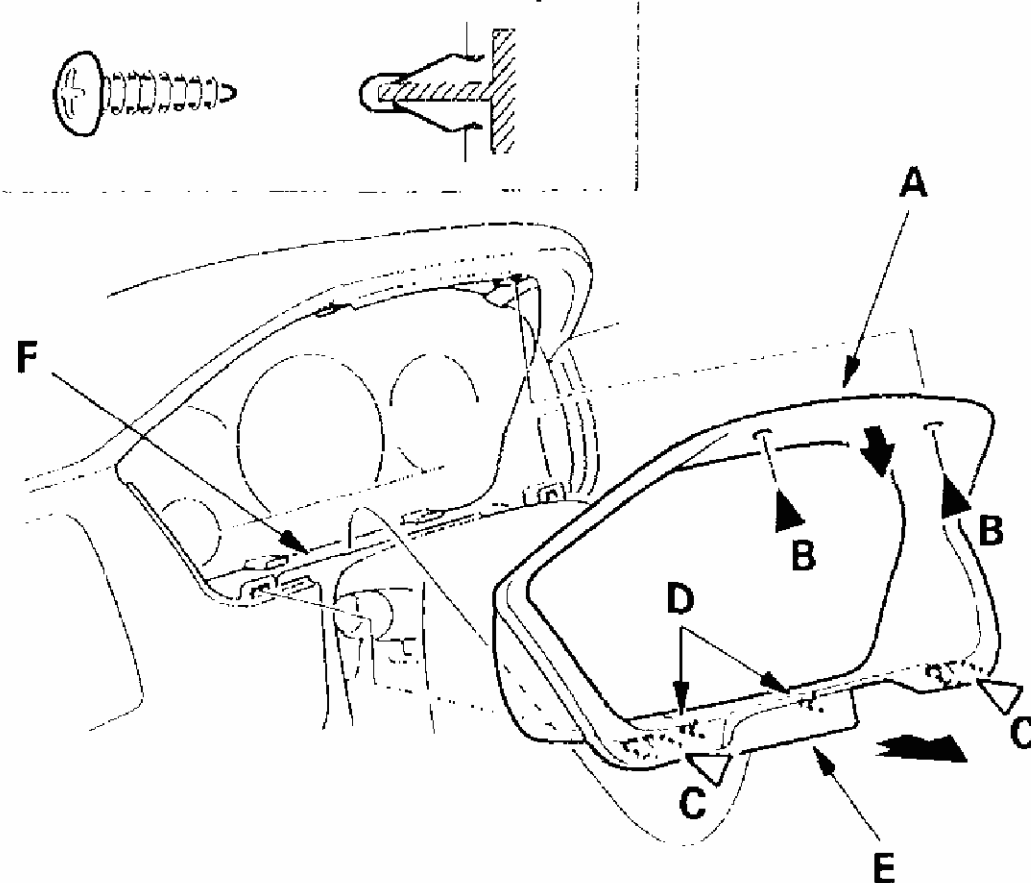

G01465452

Fig. 25: Identifying Instrument Panel Fastener Locations

Courtesy of AMERICAN HONDA MOTOR CO., INC.

3. Install the panel in the reverse order of removal, and note these items:

- Replace any damaged clips.
- Push the clips into place securely.

DRIVER'S DASHBOARD LOWER COVER REMOVAL/INSTALLATION

NOTE: **Take care not to scratch the dashboard and related parts.**

1. Remove the dashboard lower cover (A).

- Remove the screw (B).
- Pull out on the bottom of the cover to release the clips (C).
- Pull it down to release the hooks (D).

B ▶ : Screw, 1 C ▶ : Clip, 2

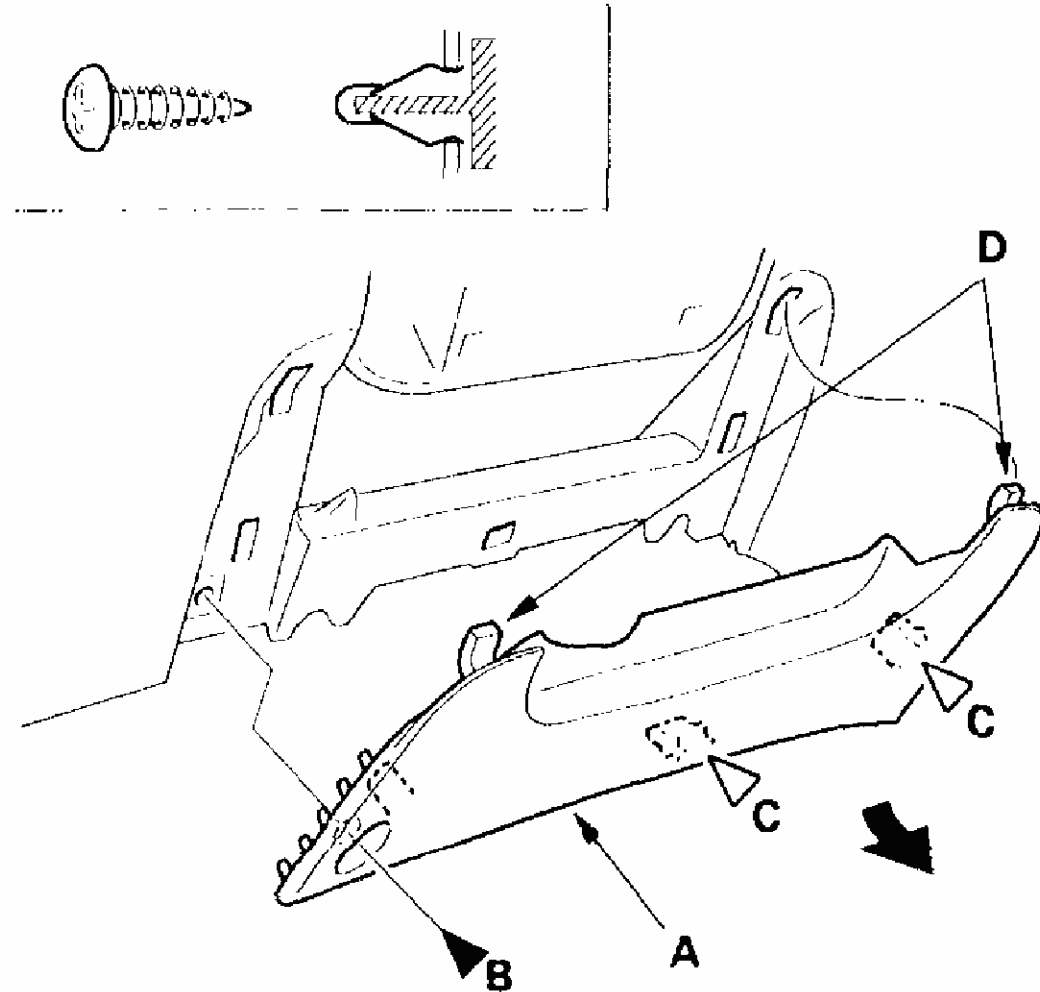

G01465453

Fig. 26: Identifying Driver's Dashboard Lower Cover Fastener Locations
Courtesy of AMERICAN HONDA MOTOR CO., INC.

2. Install the cover in the reverse order of removal, and note these items:
 - Replace any damaged clips.
 - Push the clips into place securely.

DRIVER'S PANEL REMOVAL/INSTALLATION

NOTE:

- When prying with a flat-tip screwdriver, wrap it with protective tape, and apply protective tape around the related parts to prevent damage.

- **Take care not to scratch the dashboard and related parts.**

1. Remove the instrument panel (see **INSTRUMENT PANEL REMOVAL/INSTALLATION**).
2. On the driver's side of the dashboard, remove the dashboard side lid (A).
 - A. Remove the front door opening trim (B), as necessary.
 - B. Gently pull out along the rear edge to release the clips and hooks (C).
 - C. Gently pull out on the lid to release the top and bottom clips and the hooks (D), then remove the lid.

▷ : Clip, 4

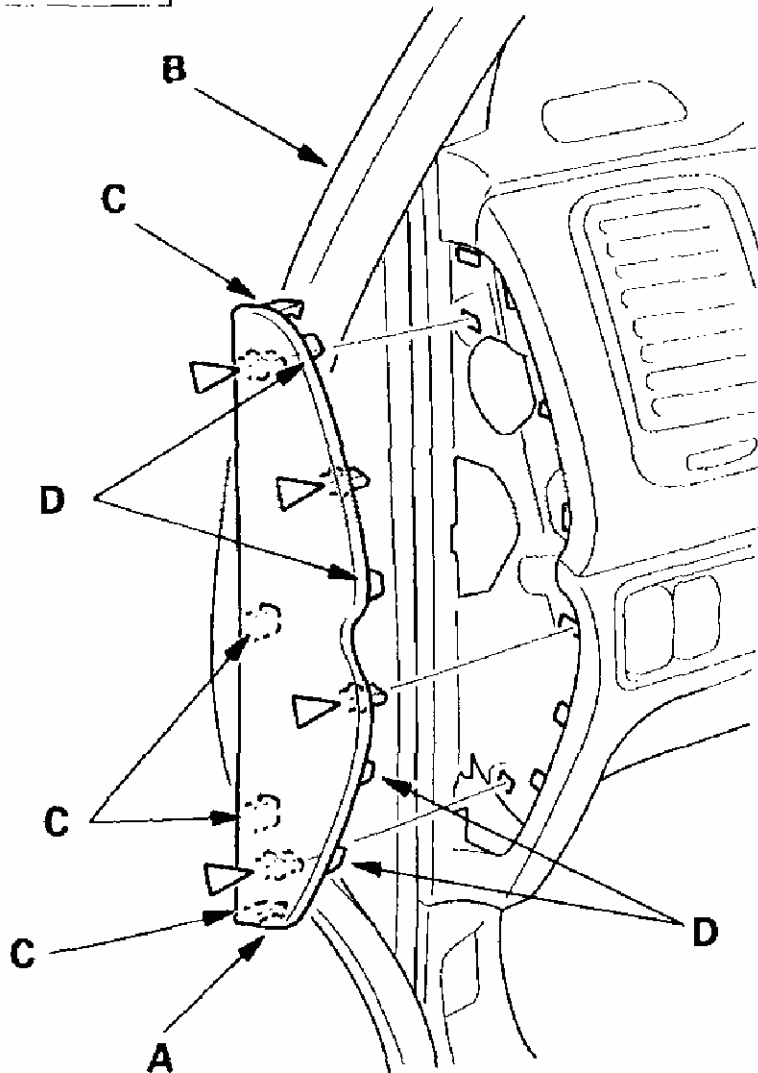
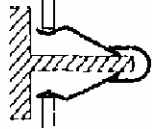

G01465454

Fig. 27: Identifying Driver's Panel Fastener Locations (1 Of 2)
Courtesy of AMERICAN HONDA MOTOR CO., INC.

3. Remove the driver's panel (A).
 - A. Gently pull out the inside edge on the panel to detach the clips (B).
 - B. On the outside edge of the dashboard, release the hooks (C) from the dashboard.

C. Gently pull out the outside edge on the panel to detach the clips (D).

B, D ▷ : Clip, 5

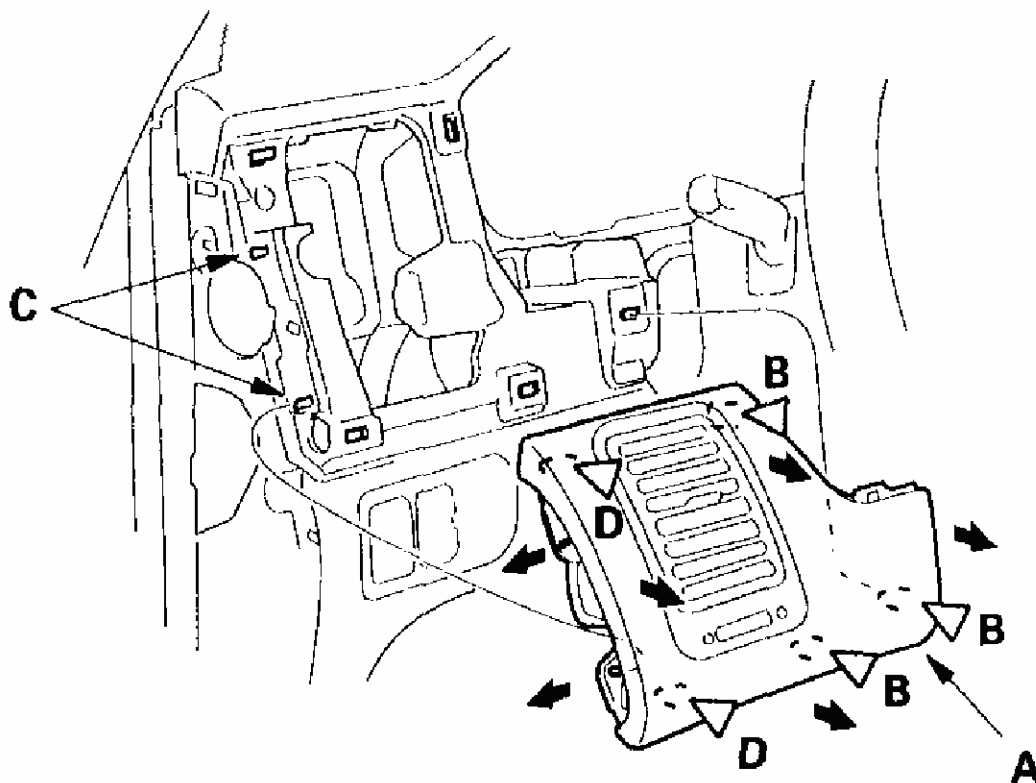
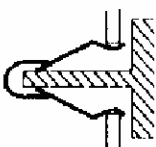

G01465455

Fig. 28: Identifying Driver's Panel Fastener Locations (2 Of 2)
Courtesy of AMERICAN HONDA MOTOR CO., INC.

4. Install the panel in the reverse order of removal, and note these items:
 - Replace any damaged clips.
 - Push the clips and hooks into place securely.

NOTE:

- **When prying with a flat-tip screwdriver, wrap it with protective tape, and apply protective tape around the related parts to prevent damage.**
- **Take care not to scratch the dashboard and related parts.**

1. Remove the driver's switch panel (A).

- A. Using a flat-tip screwdriver, pry out the bottom portion of the panel to detach the clips.
- B. Pull out the panel to release the upper hooks (B), then remove the panel.
- C. Disconnect the cruise control main switch connector (C) and interior lights switch connector (D).

▷ : Clip, 2

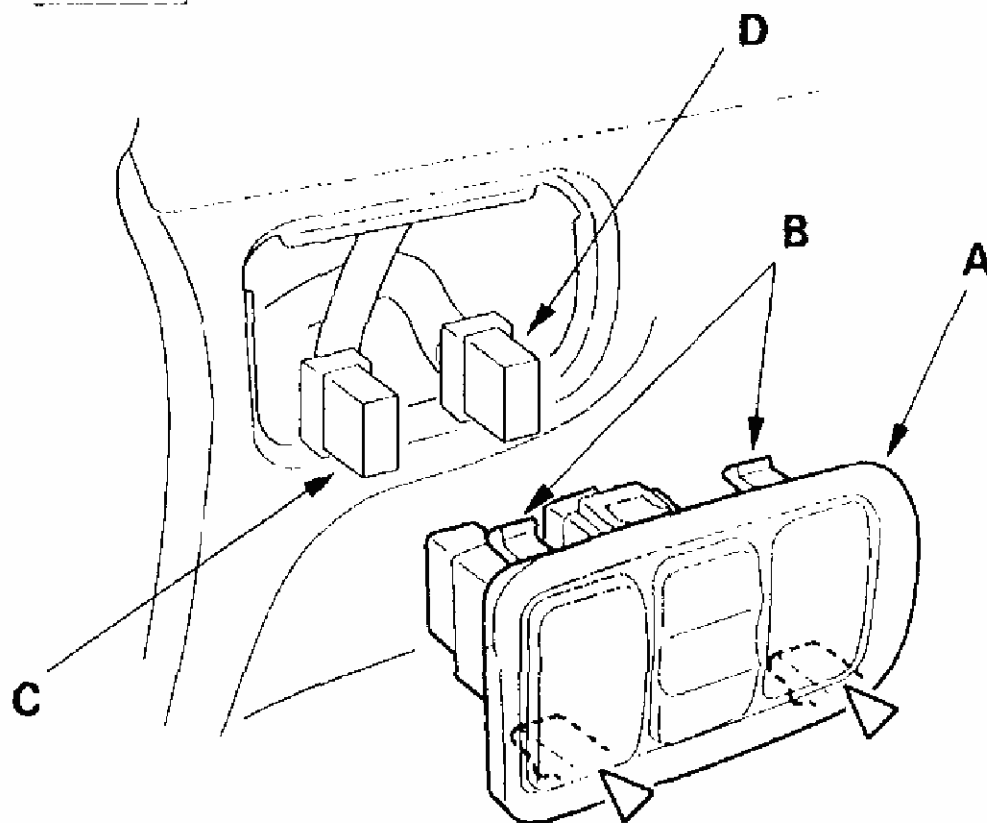
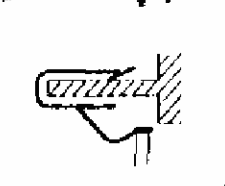

G01465456

Fig. 29: Identifying Driver's Switch Panel Fastener Locations
Courtesy of AMERICAN HONDA MOTOR CO., INC.

2. Install the panel in the reverse order of removal, and note these items:
 - Make sure each connector is plugged in properly.
 - Replace any damaged clips.
 - Push the clips and hooks into place securely.

CENTER PANEL REMOVAL/INSTALLATION

NOTE: • When prying with a flat-tip screwdriver, wrap it with

protective tape, and apply protective tape around the related parts to prevent damage.

- Take care not to scratch the dashboard and related parts.

1. On the passenger's side, use a flat-tip screwdriver to pry out the switch lid (A) at the notch (B), and remove the lid.

D ▷ : Clip, 2 E ▷ : Clip, 1

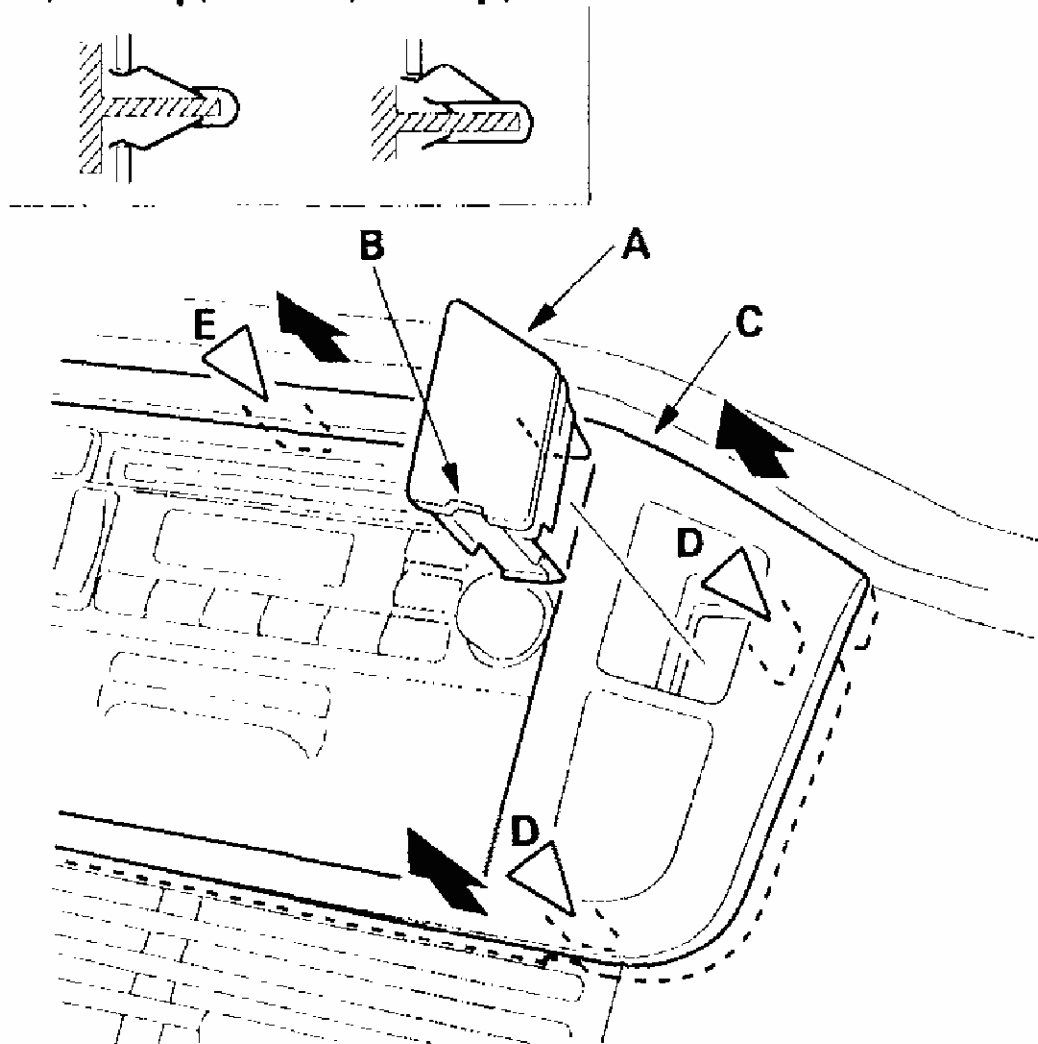

G01465457

Fig. 30: Identifying Center Panel Fastener Locations (1 Of 2)
Courtesy of AMERICAN HONDA MOTOR CO., INC.

2. Gently pull out the dashboard center panel (C) by grasping inside the switch lid hole to

detach the clips (D, E).

3. On the driver's side, gently pull out on the panel (A) to detach the side clips, then remove the panel.

▷ : **Clip, 2**

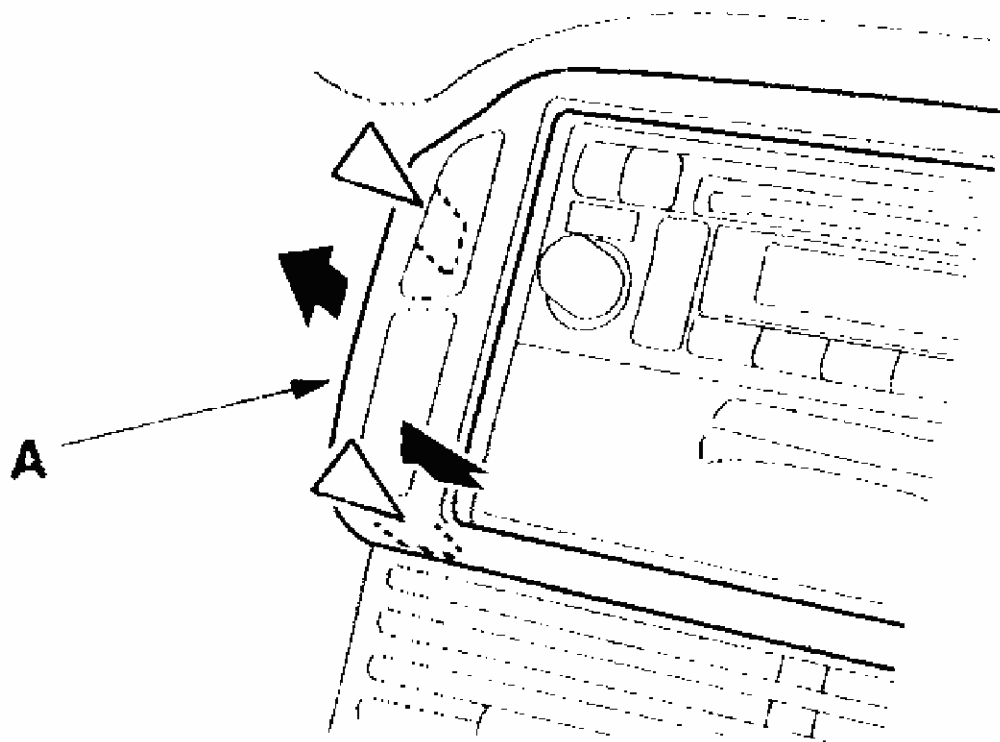
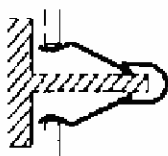

G01465458

Fig. 31: Identifying Center Panel Fastener Locations (2 Of 2)

Courtesy of AMERICAN HONDA MOTOR CO., INC.

4. Disconnect the hazard warning switch connector (A) and VTM-4 lock switch connector (B).

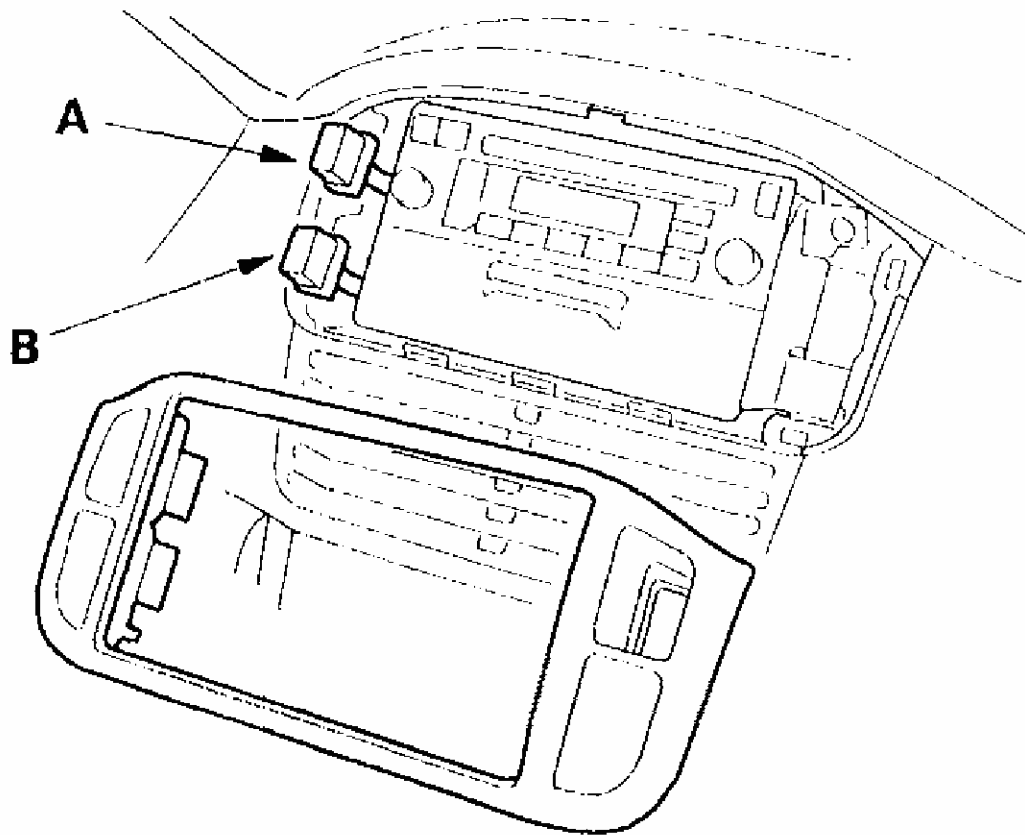

G01465459

Fig. 32: Disconnecting The Hazard Warning Switch Connector & VTM-4 Lock Switch Connector

Courtesy of AMERICAN HONDA MOTOR CO., INC.

5. Install the panel in the reverse order of removal, and note these items:
 - Make sure each connector is plugged in properly.
 - Replace any damaged clips.
 - Push the clips into place securely.

MIDDLE PANEL REMOVAL/INSTALLATION

NOTE:

- When prying with a flat-tip screwdriver, wrap it with protective tape, and apply protective tape around the related parts to prevent damage.
- Take care not to scratch the dashboard and related parts.

2003 Honda Pilot LX

2003-04 ACCESSORIES & EQUIPMENT Interior Trim - Pilot

1. Remove these items:

- Instrument panel (see **INSTRUMENT PANEL REMOVAL/INSTALLATION**).
- Center panel (see **CENTER PANEL REMOVAL/INSTALLATION**).

2. On the passenger's side of the dashboard, remove the dashboard side lid (A).

- A. Remove the front door opening trim (B), as necessary.
- B. Gently pull out along the rear edge to release the clips and hooks (C)
- C. Gently pull out on the lid to release the top and bottom clips and the 3 hooks (D), then remove the lid.

▷ : Clip, 4

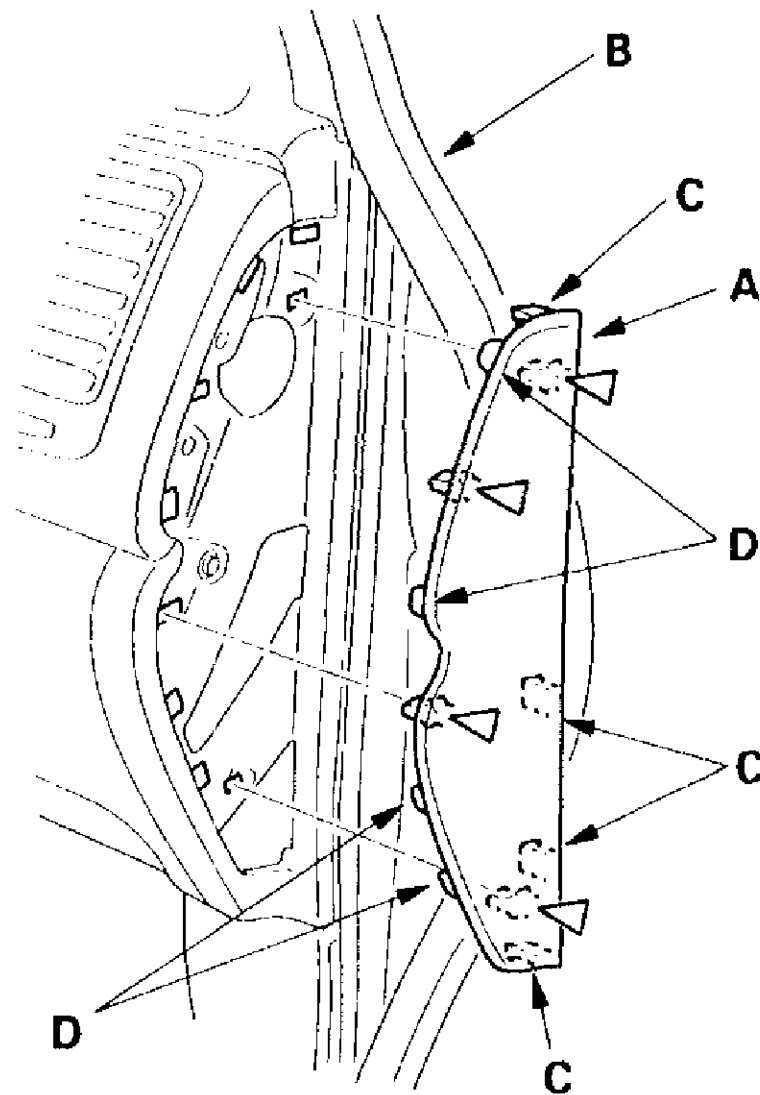
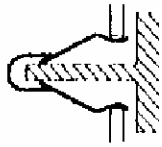

G01465460

Fig. 33: Identifying Middle Panel Fastener Locations (1 Of 3)
Courtesy of AMERICAN HONDA MOTOR CO., INC.

3. Remove the screws securing the middle panel (A).

► : Screw, 4

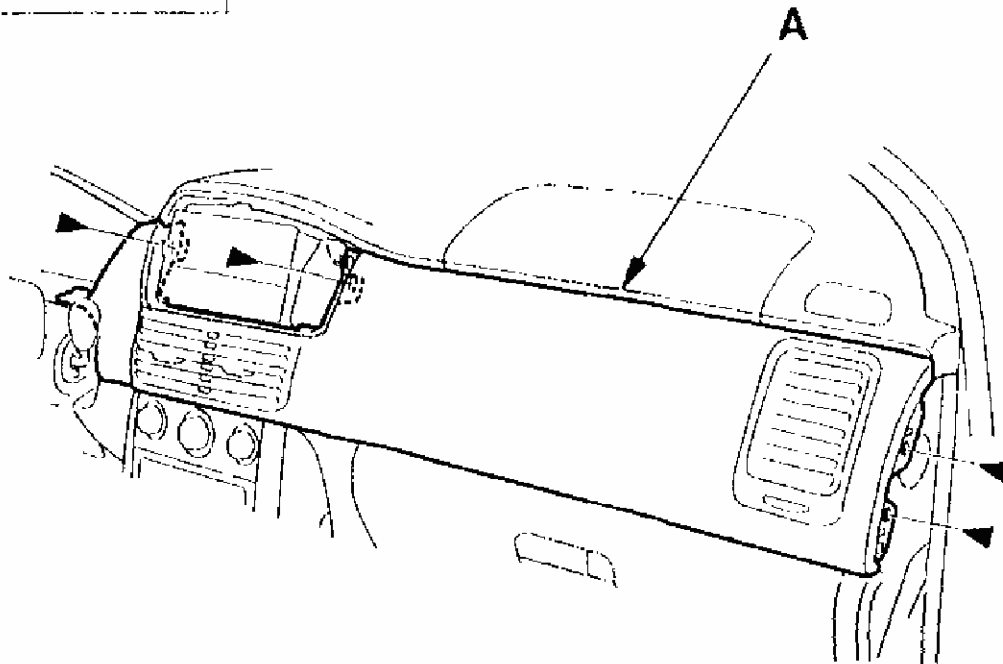
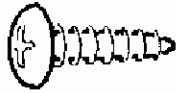

G01465461

Fig. 34: Identifying Middle Panel Fastener Locations (2 Of 3)
Courtesy of AMERICAN HONDA MOTOR CO., INC.

4. Remove the middle panel (A).
 - A. On the outside edge of the dashboard, release the hooks (B) from the dashboard.
 - B. On the passenger's side, gently pull out along the top and bottom edges on the panel to detach the clips.
 - C. On the driver's side, gently pull out on the panel to release the clips.

▷ : Clip, 16

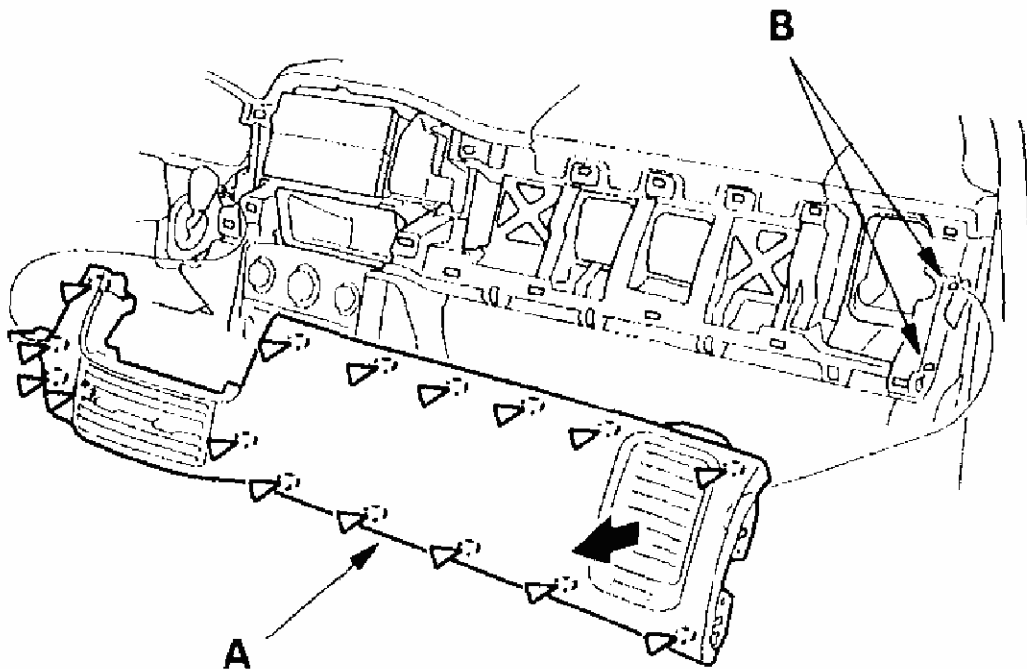
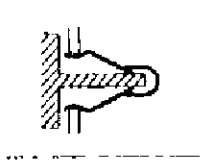

G01465462

Fig. 35: Identifying Middle Panel Fastener Locations (3 Of 3)
Courtesy of AMERICAN HONDA MOTOR CO., INC.

5. Install the panel in the reverse order of removal, and note these items:
 - Replace any damaged clips.
 - Push the clips and hooks into place securely.

GLOVE BOX REMOVAL/INSTALLATION

SRS components are located in this area. Review the SRS components locations, precautions and procedures before performing repairs or service. For 2004 models, see **AIR BAG RESTRAINT SYSTEMS** . For 2003 models, see **AIR BAG RESTRAINT SYSTEMS** .

NOTE: Take care not to scratch the dashboard and related parts.

1. Remove the right kick panel (see **TRIM REMOVAL/INSTALLATION - DOOR AREA**).
2. While holding the glove box (A), remove the glove box stop (B) on each side.

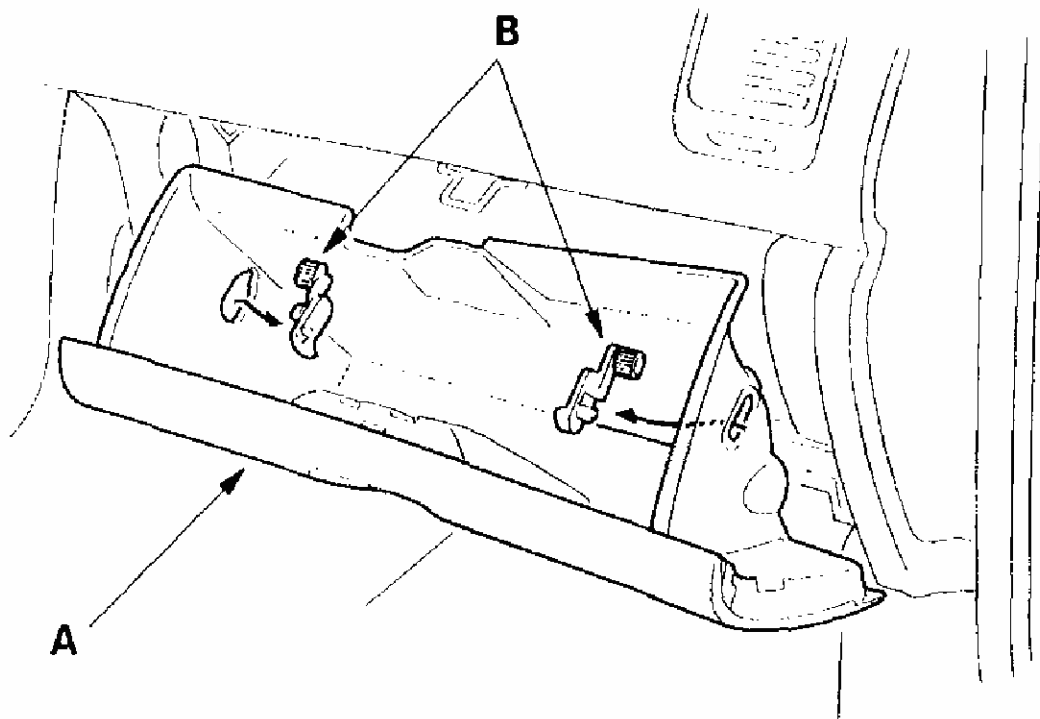

G01465463

Fig. 36: Removing The Glove Box Stops
Courtesy of AMERICAN HONDA MOTOR CO., INC.

3. Remove the bolts, then remove the glove box (A).

► : Bolt, 2

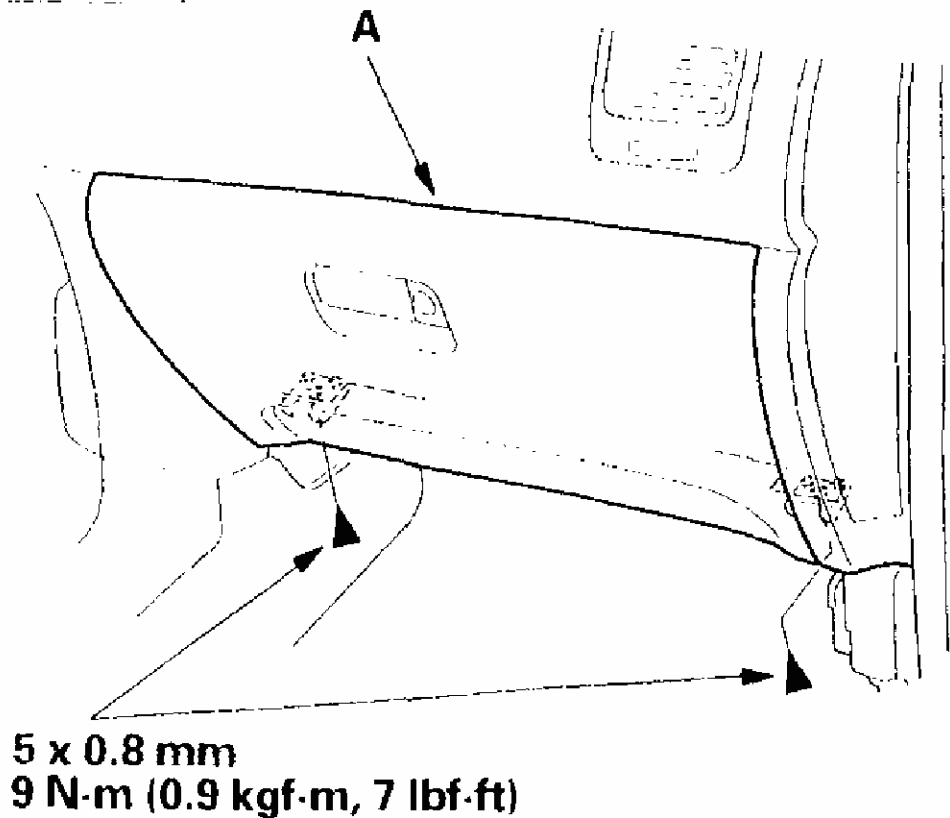
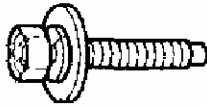

G01465464

Fig. 37: Identifying Glove Box Fastener Locations
Courtesy of AMERICAN HONDA MOTOR CO., INC.

4. Install the glove box in the reverse order of removal.

DASHBOARD SIDE VENT REMOVAL/INSTALLATION

NOTE:

- Take care not to scratch the driver's panel or middle panel.
- The driver's side vent is shown, the passenger's side vent is similar.

1. Remove the dashboard side vent (A).

- A. Wrap a flat-tip screwdriver with protective tape, and apply protective tape around the related parts to prevent damage.
- B. Carefully insert a flat-tip screwdriver next to the upper pivot portion (B).
- C. Gently pry out on the side vent to release the upper pivot portion.
- D. Release the bottom pivot portion (C).
- E. If necessary, remove the bottom pivot bushing (D).

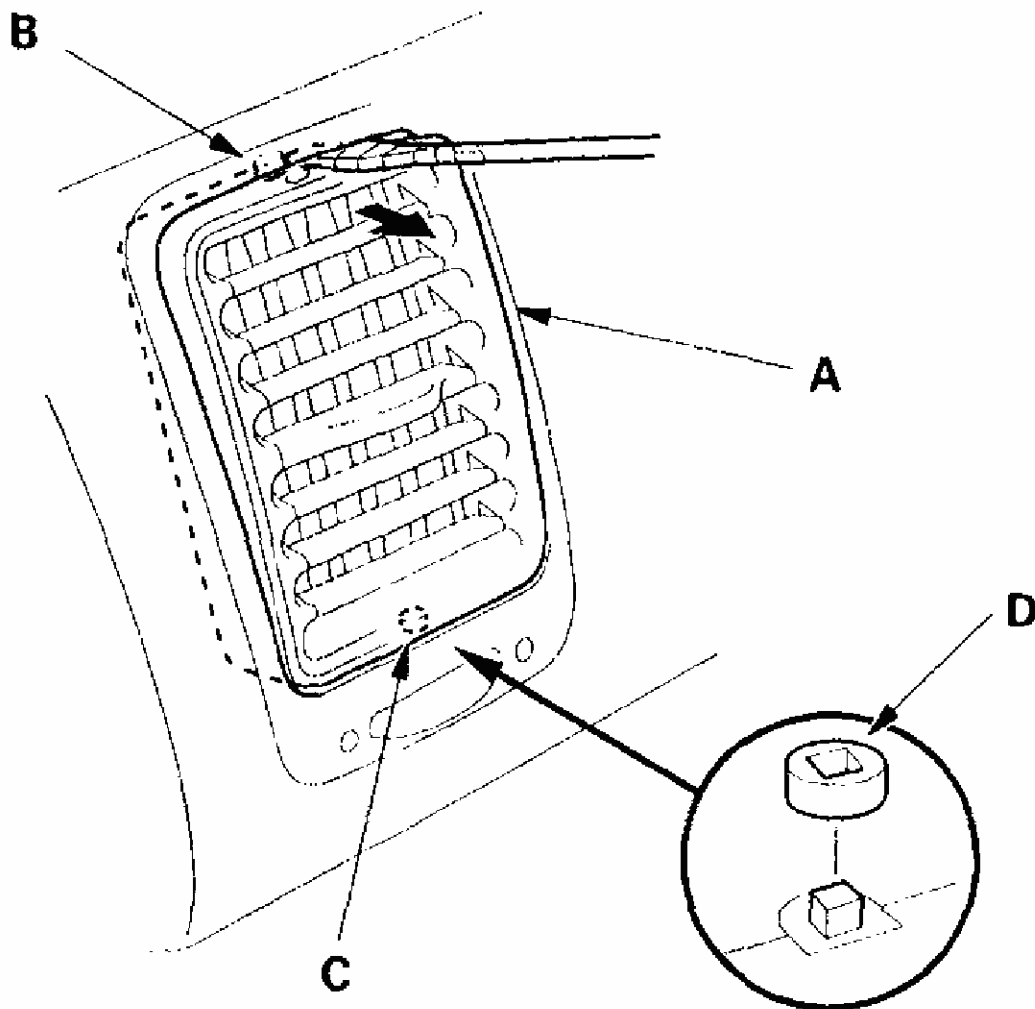

G01465465

Fig. 38: Removing The Dashboard Side Vent**Courtesy of AMERICAN HONDA MOTOR CO., INC.**

- 2. Reinstall the side vent onto the bottom pivot portion first, then reinstall it onto the upper pivot portion. Make sure that both pivot portions are installed securely.

DASHBOARD REMOVAL/INSTALLATION

SRS components are located in this area. Review the SRS components locations, precautions and procedures before performing repairs or service. For 2004 models, see **AIR BAG RESTRAINT SYSTEMS** . For 2003 models, see **AIR BAG RESTRAINT SYSTEMS** .

NOTE:

- When prying with a flat-tip screwdriver, wrap it with protective tape, and apply protective tape around the related parts to prevent damage.
- Have an assistant help you when removing and installing the dashboard.
- Take care not to scratch the dashboard, body, and other related parts.
- Put on gloves to protect your hands.

1. Make sure you have the anti-theft codes for the radio and the navigation system, then write down the frequencies for the preset buttons.
2. Disconnect the negative cable from the battery, and wait at least 3 minutes before beginning work.
3. Remove these items:
 - Center console (see **CENTER CONSOLE REMOVAL/INSTALLATION**).
 - Driver's dashboard lower cover (see **DRIVER'S DASHBOARD LOWER COVER REMOVAL/INSTALLATION**).
 - Dashboard side lid, passenger's side (see step 2 on **MIDDLE PANEL REMOVAL/INSTALLATION**).
 - Glove box (see **GLOVE BOX REMOVAL/INSTALLATION**).
 - Kick panels, both sides (see **TRIM REMOVAL/INSTALLATION - DOOR AREA**).
 - A-pillar trim, both sides (see **TRIM REMOVAL/INSTALLATION - DOOR AREA**).
 - Steering column (see **STEERING COLUMN REMOVAL & INSTALLATION**).
 - A-pillar corner trim, driver's side (see **A-PILLAR CORNER TRIM REPLACEMENT**).
4. With navigation system, remove these items:
 - Front seat, passenger's side (see **FRONT SEAT REMOVAL/INSTALLATION**).
 - Carpet, passenger's side as necessary (see **CARPET REPLACEMENT**).

Driver's Side

5. From under the dash, disconnect the side wire harness connectors (A), engine compartment wire harness connectors (B), door wire harness connectors (C), dashboard wire harness connectors (D), interior wire harness connectors (E), brake pedal position switch connector (F), and parking brake switch connector (G). Detach the wire harness clip (H).

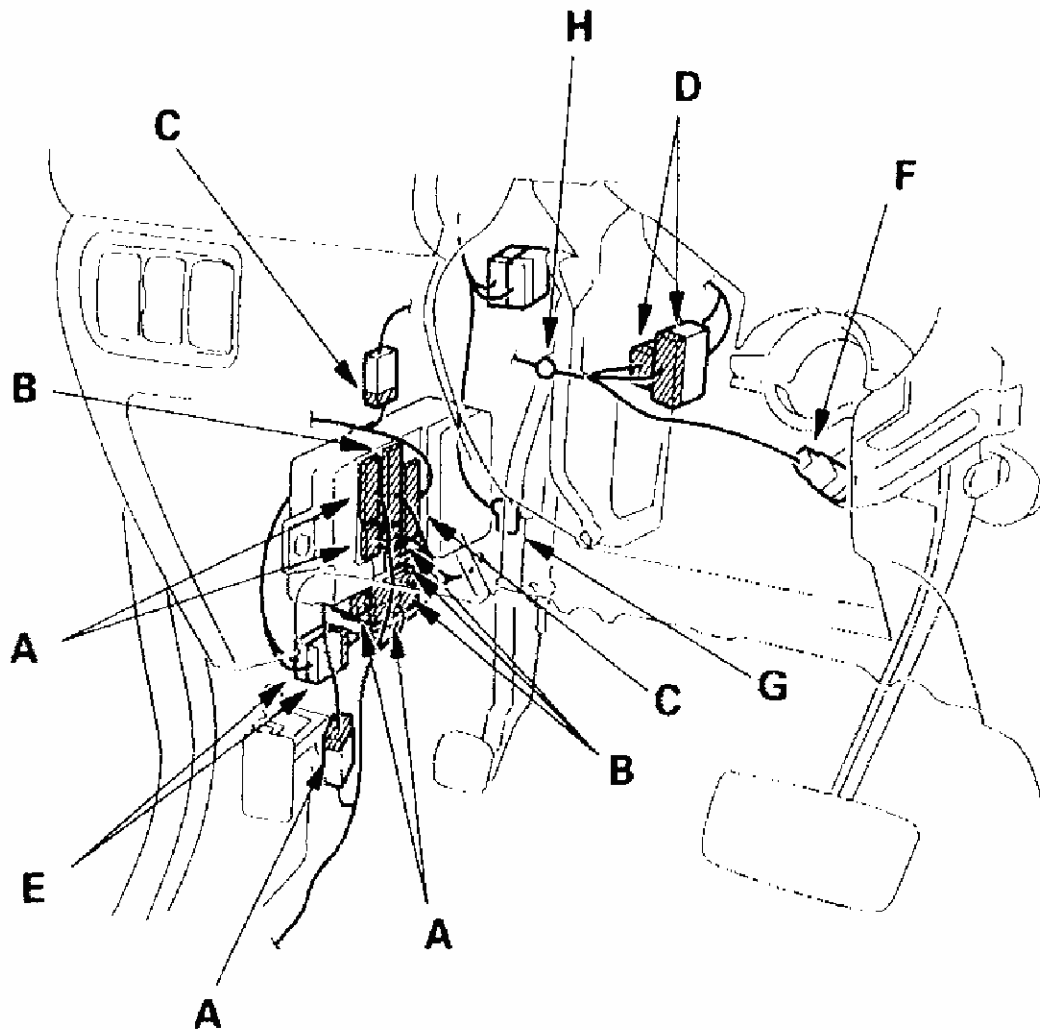

G01465466

Fig. 39: Identifying Under-Dash Connectors

Courtesy of AMERICAN HONDA MOTOR CO., INC.

Middle Portion

6. On the driver's side, disconnect the PCM connector (A), SRS unit connectors (B), mode

motor connector (C), and the in-car temperature sensor hose (D), and with a Torx T30 bit, remove the ground bolt (E). Detach the wire harness clips (F).

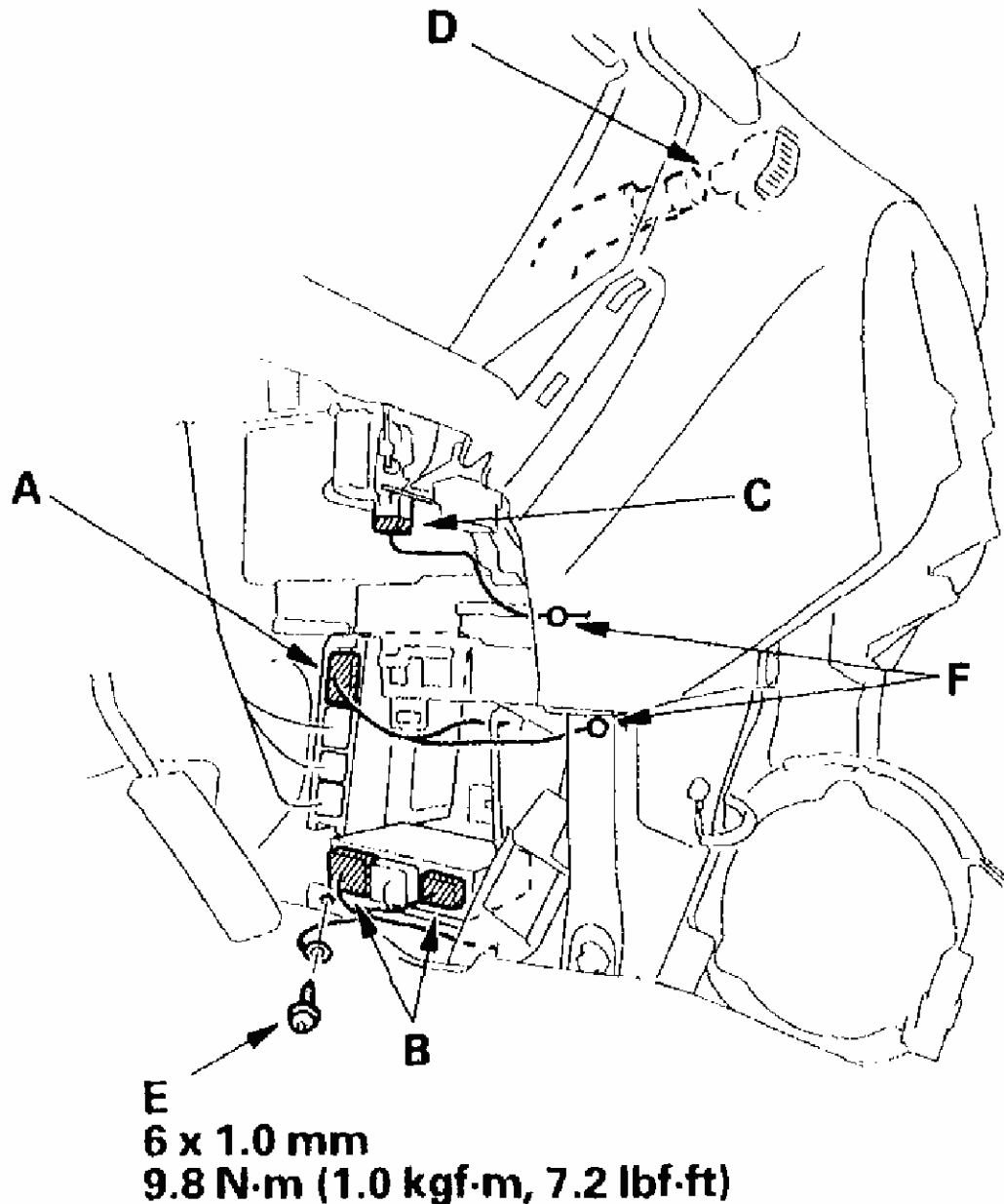

G01465467

Fig. 40: Identifying Driver's Side Connectors

Courtesy of AMERICAN HONDA MOTOR CO., INC.

7. On the inside of the dashboard center frame, disconnect the SRS floor wire harness connectors (A) and rear A/C subwire harness connectors (B), and detach the wire harness

clips (C).

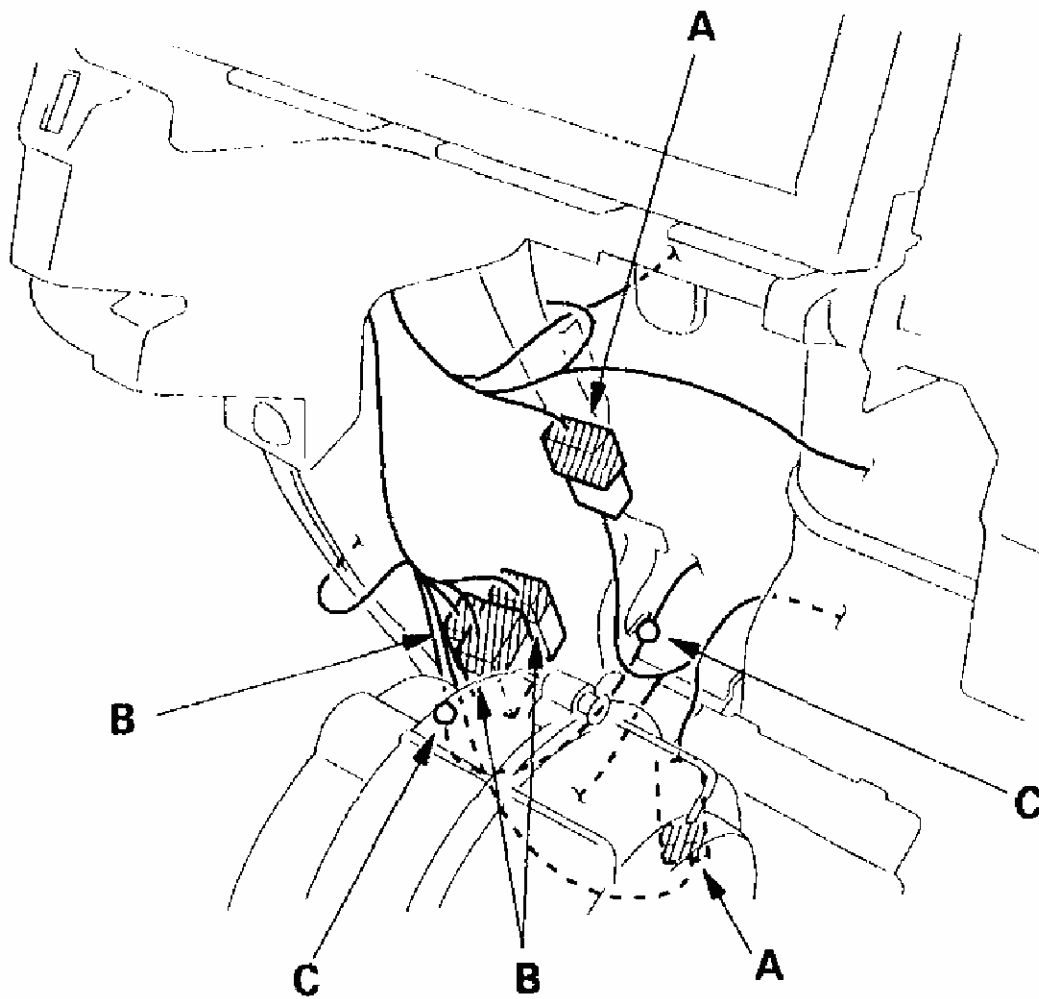

G01465468

Fig. 41: Identifying In-Dash Connectors

Courtesy of AMERICAN HONDA MOTOR CO., INC.

8. On the passenger's side, disconnect the evaporator temperature sensor connector (A), air mix control motor connector (B), PCM subwire harness connector (C), and antenna lead and wire harness clip (D). With navigation system, release the navigation subwire harness (E) and GPS antenna harness (F) from the floor.

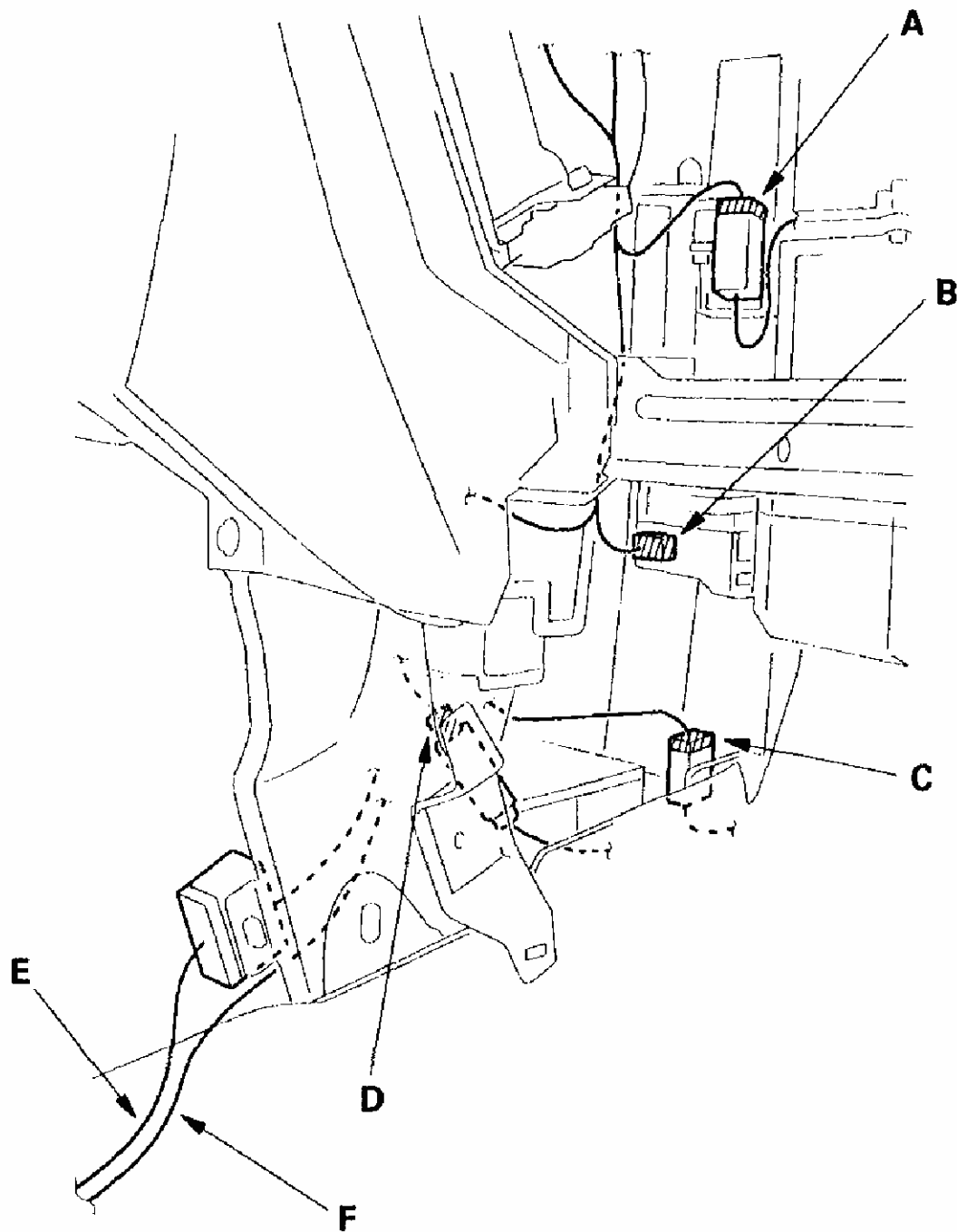

G01465469

Fig. 42: Identifying Passenger's Side Connectors
Courtesy of AMERICAN HONDA MOTOR CO., INC.

Passenger's Side

9. Remove the bolt (A), and pull out the fuse/relay box (B). Disconnect the side wire

harness connectors (C), engine compartment wire harness connectors (D), door wire harness connectors (E), interior wire harness connector (F), recirculation control motor connector (G), power transistor connector (H), and blower motor connector (I).

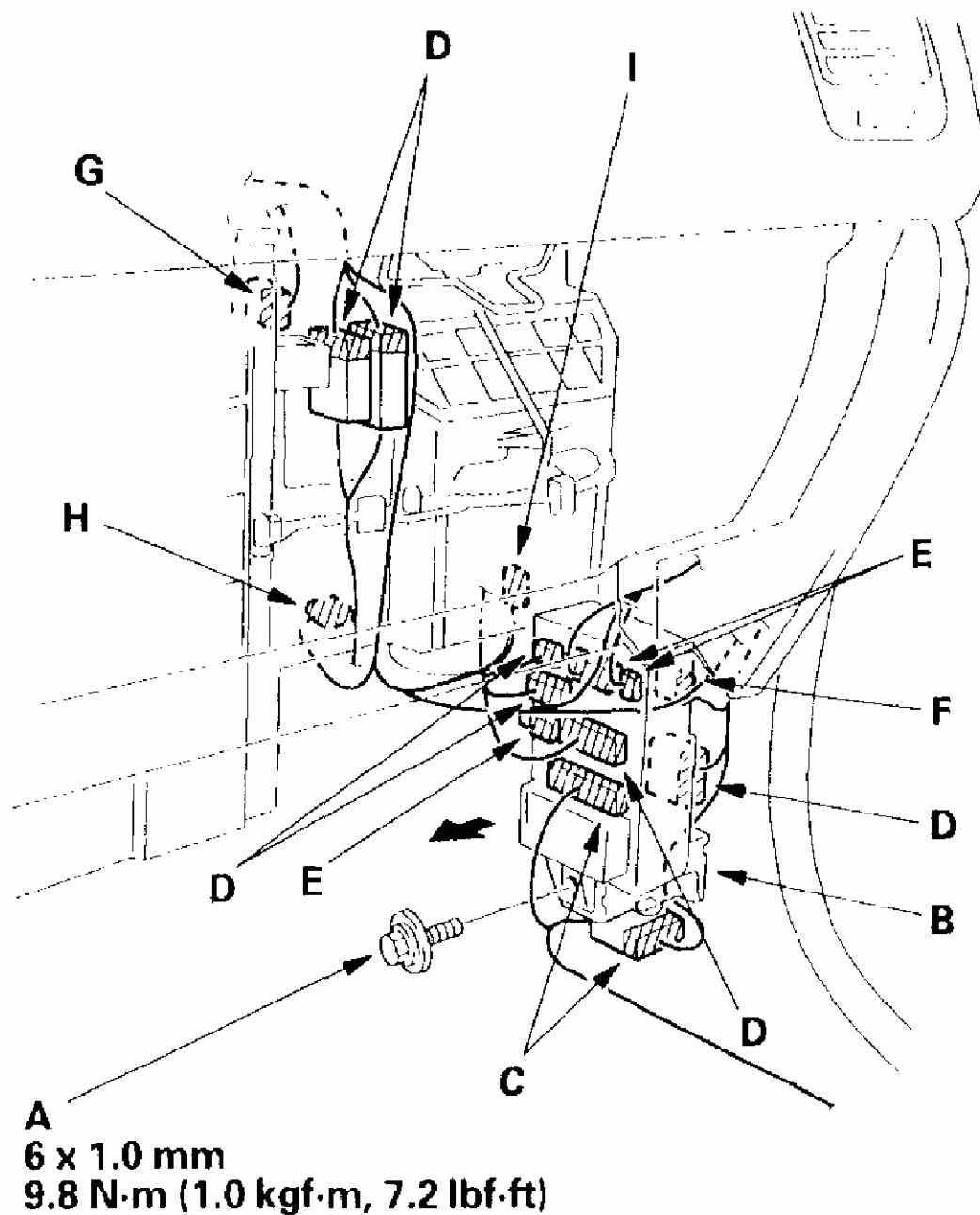

G01465470

Fig. 43: Identifying Connectors

Courtesy of AMERICAN HONDA MOTOR CO., INC.

2003 Honda Pilot LX

2003-04 ACCESSORIES & EQUIPMENT Interior Trim - Pilot

10. Detach all of the harness and connector clips.
11. Remove the bolts (A, B, C, D, E, F), and lift up on the dashboard (G) to release it from the guide pins (H, I) on the body.

2003 Honda Pilot LX

2003-04 ACCESSORIES & EQUIPMENT Interior Trim - Pilot

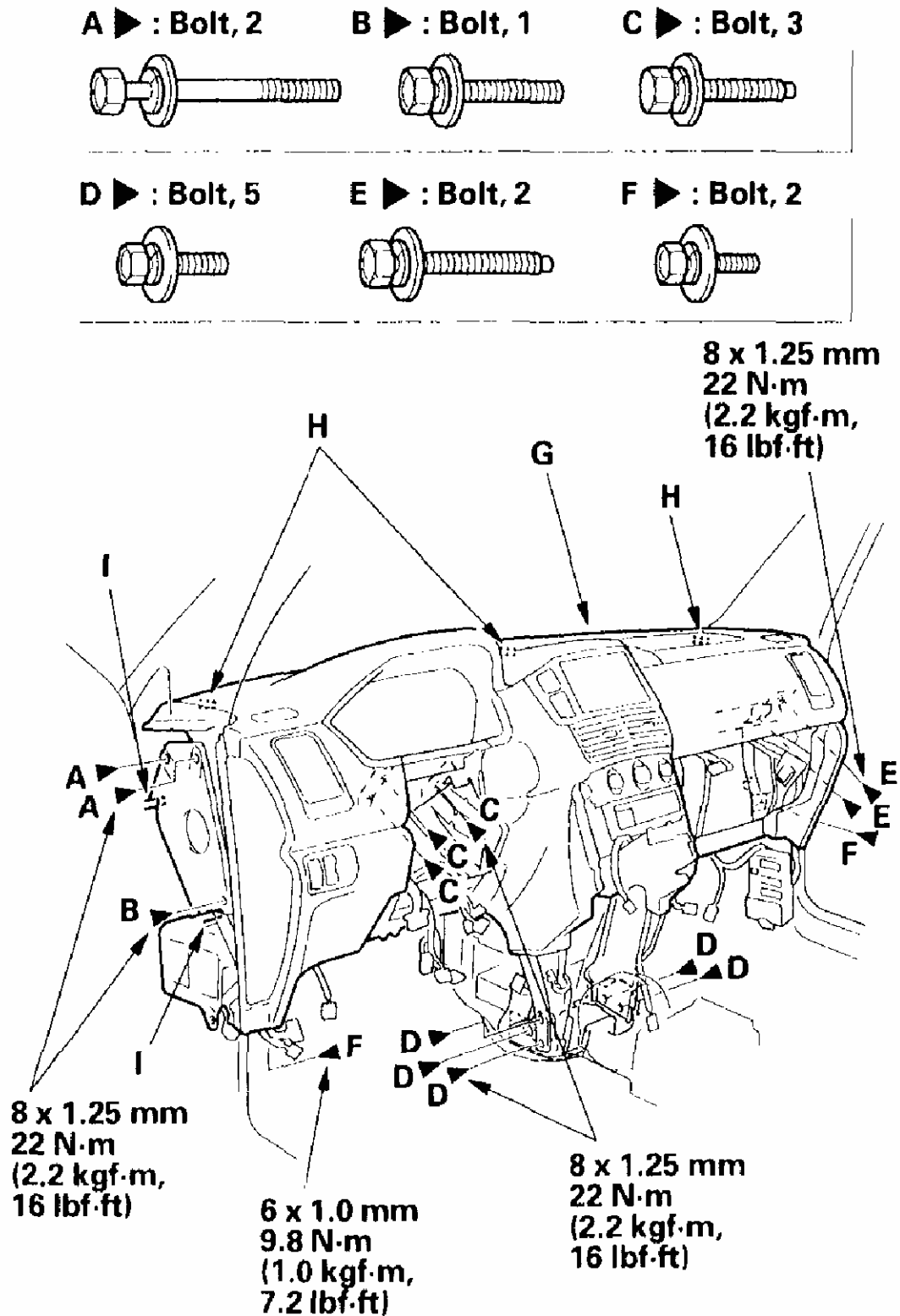

G01465471

Fig. 44: Identifying Dashboard Fastener Locations

Courtesy of AMERICAN HONDA MOTOR CO., INC.

12. Carefully remove the dashboard through the front door opening.
13. Install the dashboard in the reverse order of removal, and note these items:
 - Make sure the dashboard fits onto the guide pins correctly.
 - Apply liquid thread lock to the center frame mounting bolts before reinstallation.
 - Make sure the center frames are installed on the center bracket properly.
 - Before tightening the bolts, make sure each wire harness is not pinched.
 - Make sure the connectors are plugged in properly, and the antenna lead is connected properly.
 - Reconnect the negative cable to the battery.
 - Enter the anti-theft code for the radio, then enter the customer's radio station presets.
 - Reset the clock.
 - Do the PCM idle learn procedure (see **PCM IDLE LEARN PROCEDURE**), and the power window control unit reset procedure (see **RESETTING THE POWER WINDOW CONTROL UNIT**).

STEERING HANGER BEAM REPLACEMENT

- NOTE:**
- Have an assistant help you when removing and installing the steering hanger beam.
 - Take care not to scratch the dashboard.
 - Put on gloves to protect your hands.

1. Remove the dashboard (see **DASHBOARD REMOVAL/INSTALLATION**).
2. Remove these items from the dashboard:
 - Instrument panel (see **INSTRUMENT PANEL REMOVAL/INSTALLATION**).
 - Gauge assembly (see **GAUGE ASSEMBLY REPLACEMENT**).
 - Driver's switch panel (see page **DRIVER'S SWITCH PANEL REMOVAL/INSTALLATION**).
 - Driver's panel (see **DRIVER'S PANEL REMOVAL/INSTALLATION**).
 - Center panel (see **CENTER PANEL REMOVAL/INSTALLATION**).
 - Middle panel (see **MIDDLE PANEL REMOVAL/INSTALLATION**).
 - Audio unit (see **AUDIO UNIT REMOVAL/INSTALLATION**).
 - Display unit, with navigation system (see **DISPLAY UNIT REMOVAL/INSTALLATION**).

- Climate control unit (see **CLIMATE CONTROL UNIT REMOVAL AND INSTALLATION**).

3. On the driver's side of the dashboard, remove the nut (A), and pull out the fuse/relay box (B). Disconnect the dashboard wire harness connectors (C), and detach all of the dashboard wire harness clips and connectors.

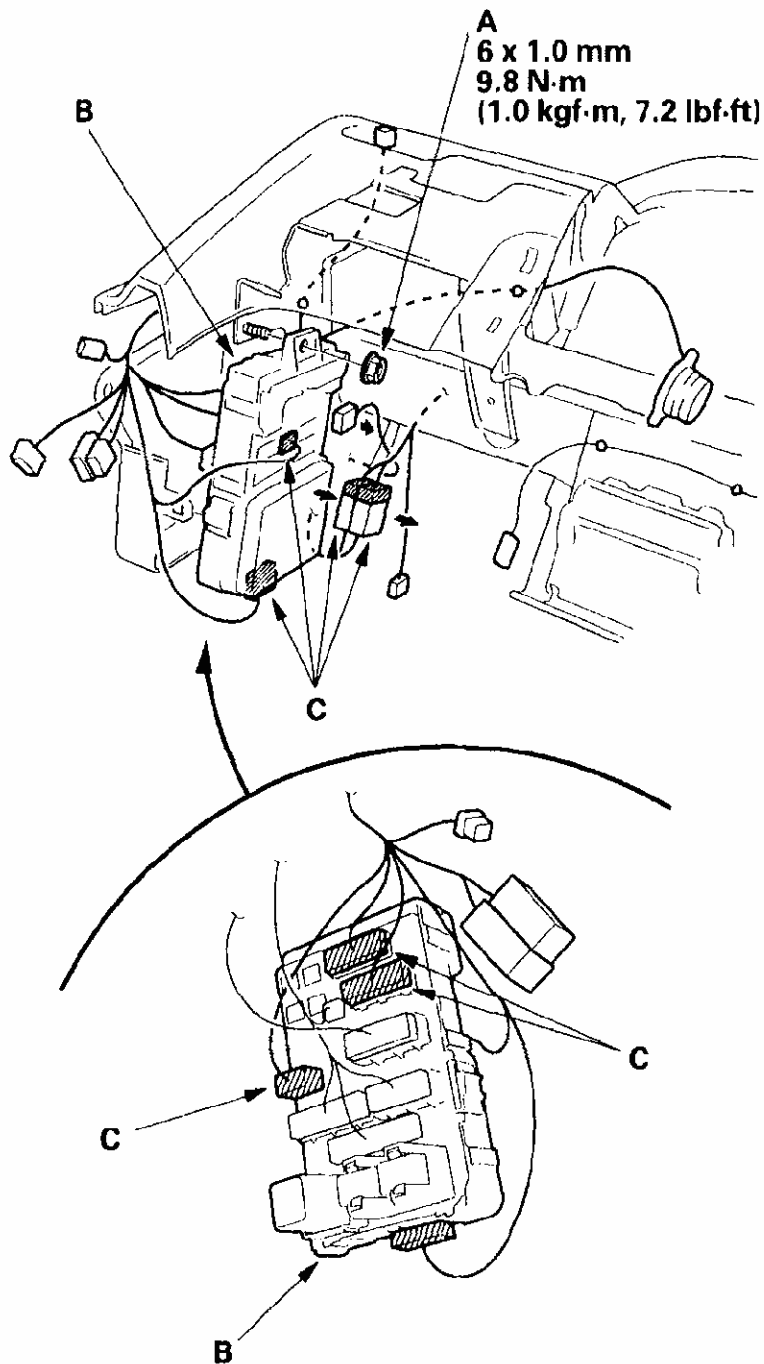

Fig. 45: Detaching The Dashboard Wire Harness Clips & Connectors
Courtesy of AMERICAN HONDA MOTOR CO., INC.

4. On the driver's outside edge of the dashboard, remove the ground bolts (A), and detach all of the harness clips.

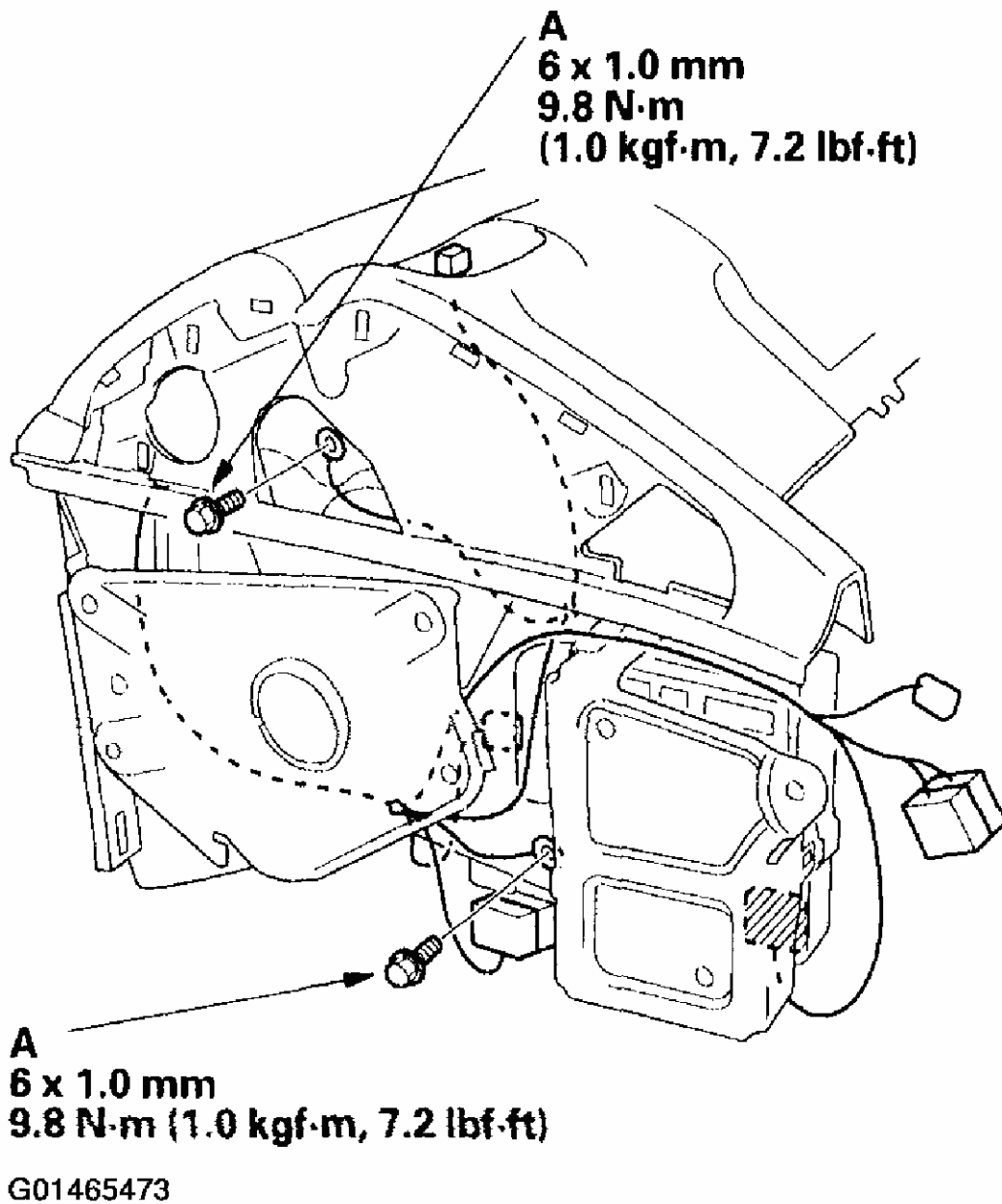
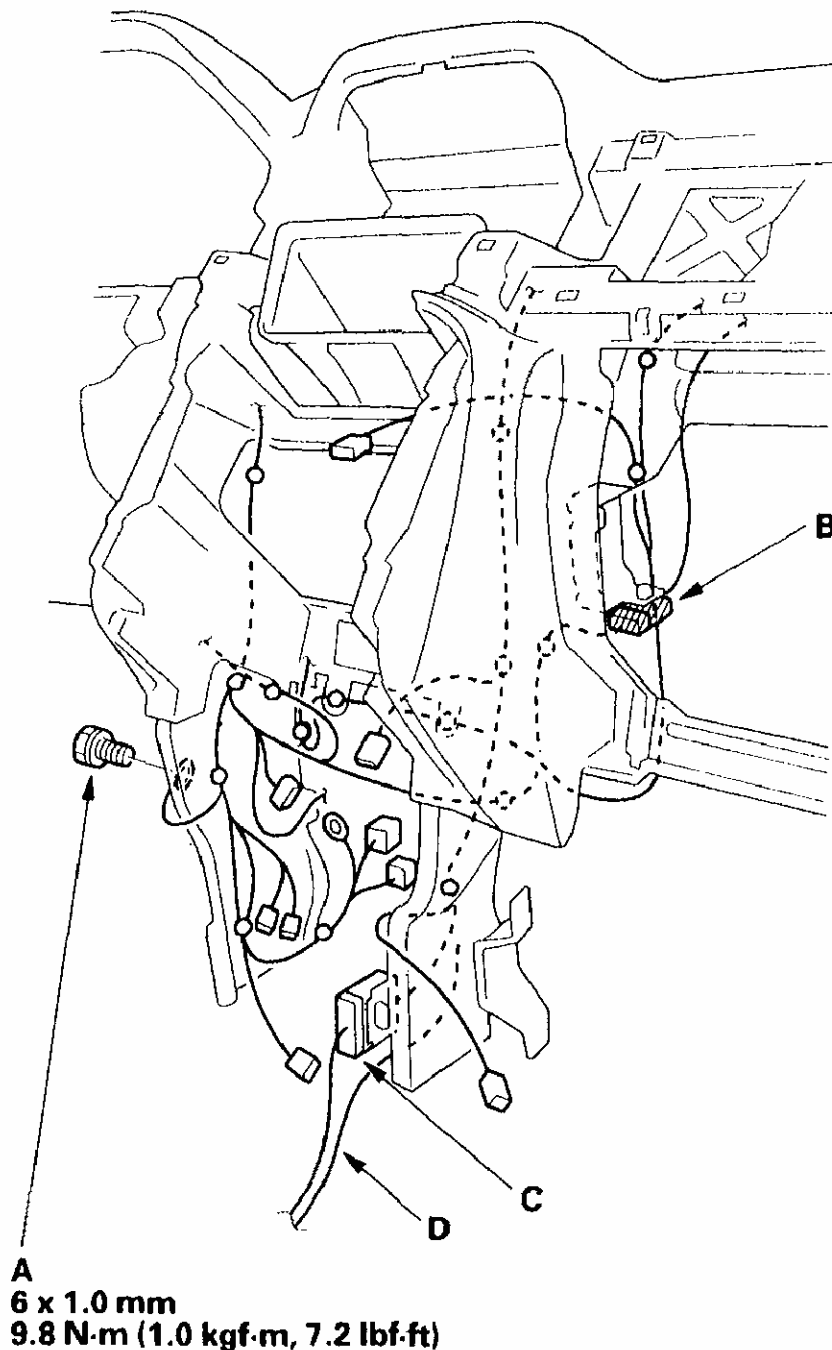

Fig. 46: Detaching The Harness Clips
Courtesy of AMERICAN HONDA MOTOR CO., INC.

5. In the middle portion of the dashboard, remove the ground bolt (A), and disconnect the

front passenger's airbag connector (B). Detach all of the dashboard wire harness clips, and with navigation system, detach the navigation subwire harness connector (C), and release the GPS antenna harness (D) by detaching the clips from the steering hanger beam.



G01465474

Fig. 47: Identifying Connectors
Courtesy of AMERICAN HONDA MOTOR CO., INC.

6. On the passenger's side, remove the ground bolt (A), and disconnect the dashboard wire harness connector (B), keyless entry control unit connector (C), and condenser connector (D). Detach all of the dashboard wire harness clips.

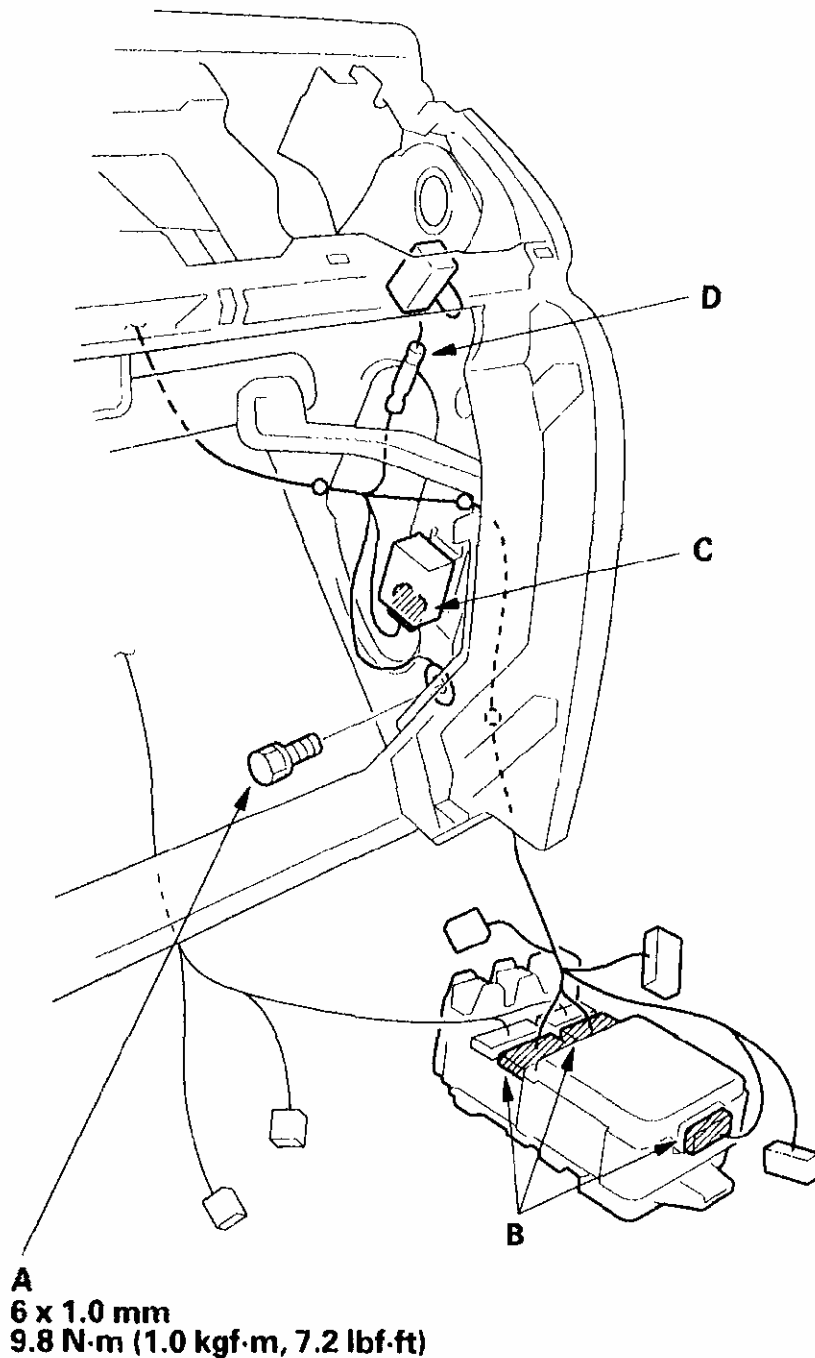

G01465475

Fig. 48: Identifying Connectors
Courtesy of AMERICAN HONDA MOTOR CO., INC.

7. On the front of the dashboard (A), remove the screws (B) and front passenger's airbag mounting nuts (C).

B ► : Screw, 17 C ● : Nut, 4

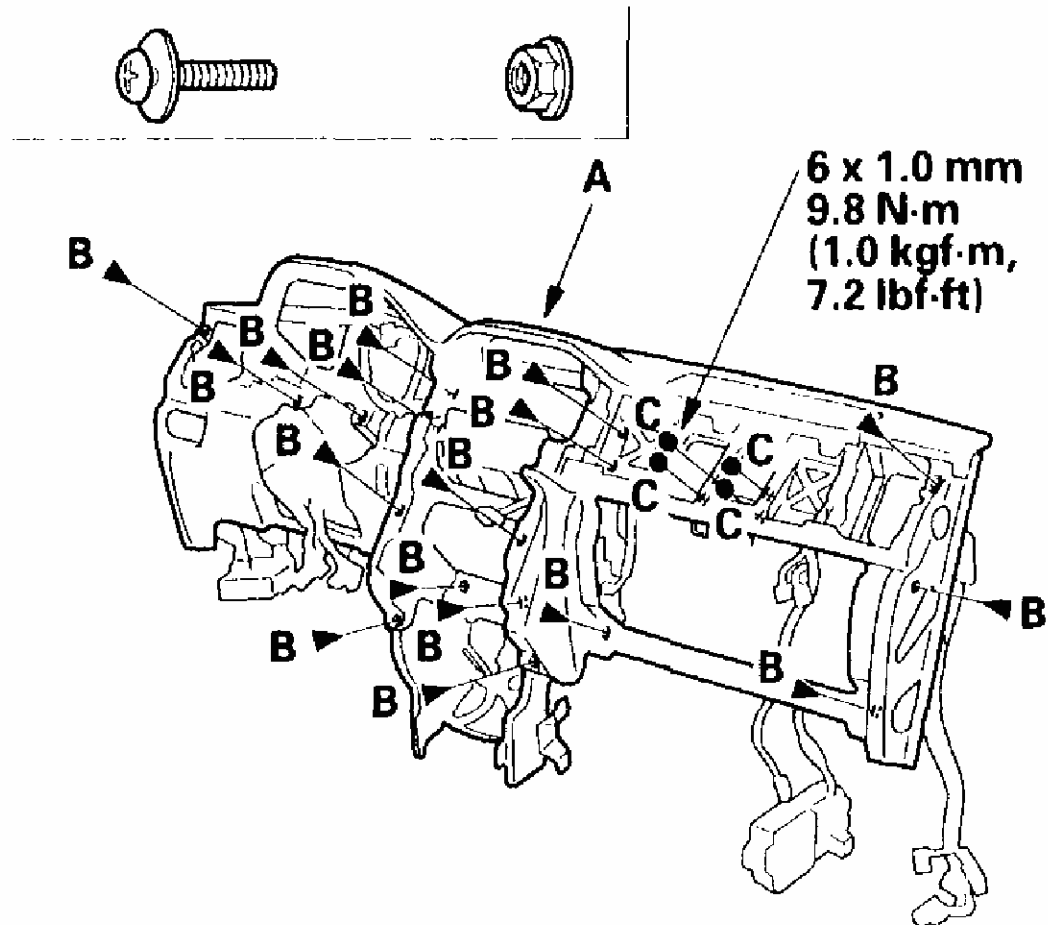

G01465476

Fig. 49: Identifying Steering Hanger Fastener Locations (1 Of 2)
Courtesy of AMERICAN HONDA MOTOR CO., INC.

8. On the back of the dashboard (A), remove the screws.

► : Screw, 4

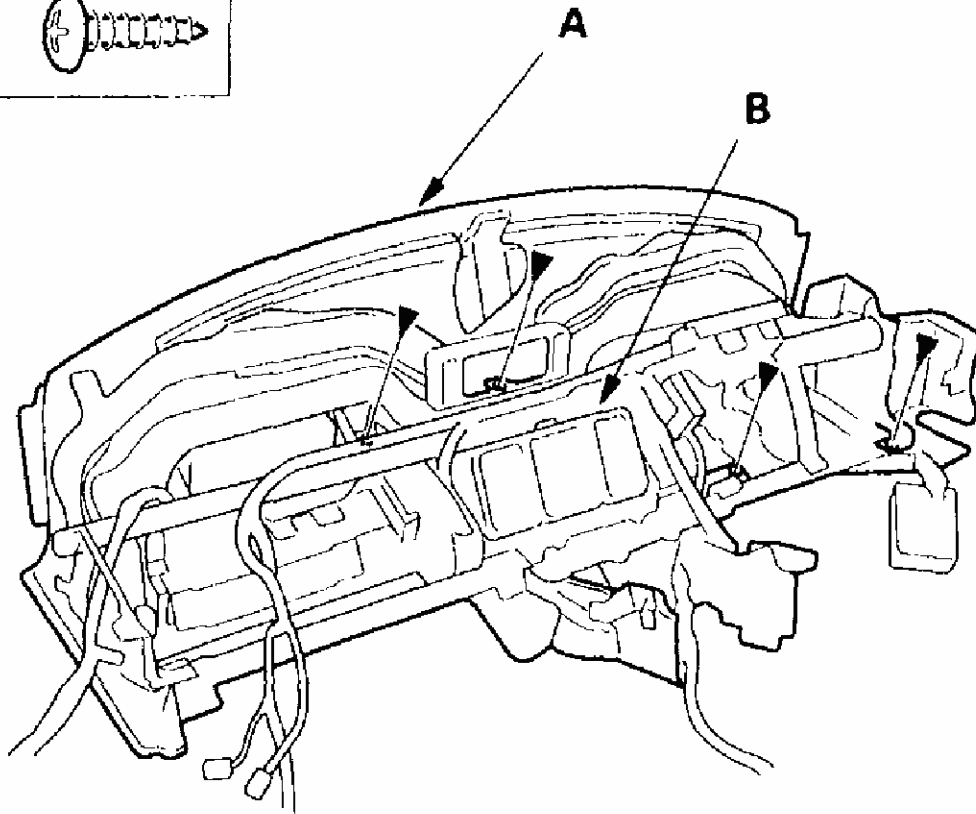

G01465477

Fig. 50: Identifying Steering Hanger Fastener Locations (2 Of 2)
Courtesy of AMERICAN HONDA MOTOR CO., INC.

9. With the help of an assistant, separate the dashboard and steering hanger beam (B).
10. Install the beam in the reverse order of removal, and note these items:
 - Make sure the dashboard wire harness and steering hanger beam wire harness are not pinched.
 - Make sure the connectors are plugged in properly.

2003 Honda Pilot LX
2003-04 ACCESSORIES & EQUIPMENT Interior Trim - Pilot

2003 Honda Pilot LX
2003-04 ACCESSORIES & EQUIPMENT Interior Trim - Pilot

2003 Honda Pilot LX
2003-04 ACCESSORIES & EQUIPMENT Interior Trim - Pilot

2003 Honda Pilot LX
2003-04 ACCESSORIES & EQUIPMENT Interior Trim - Pilot

2003 Honda Pilot LX
2003-04 ACCESSORIES & EQUIPMENT Interior Trim - Pilot

2003 Honda Pilot LX
2003-04 ACCESSORIES & EQUIPMENT Interior Trim - Pilot

2003 Honda Pilot LX
2003-04 ACCESSORIES & EQUIPMENT Interior Trim - Pilot

2003 Honda Pilot LX
2003-04 ACCESSORIES & EQUIPMENT Interior Trim - Pilot